

NOTICE!!

These documents have been scanned!

Do not place un-scanned documents beneath this notice!

Do not remove this notice from this file!

GPO Jacket No. 560-102
Print Order 61540
Rise Business Services, LLC
Job=AZ15 5/13/2019



Box Number= AZ15042



Claim Begin-End: AMC420456-AMC420456

1 Initial Receipt



AZ15042-10

AMC420196-AMC421069

United States Department of the Interior
 Bureau of Land Management
 LANDS/RECREATION & PLANNING
 ONE N CENTRAL AVE
 PHOENIX, AZ 85004 -2203
 Phone: 602-417-9200

Receipt

No:

2714951

Transaction #: 2797336		ENTERED INTO COMPUTER
Date of Transaction: 12/28/2012		
CUSTOMER:		JAN 31 2013 <i>RS</i>
ROBERT REAVES 23550 S BUMBLE BEE RD MAYER, AZ 86333-9533 US		

LINE #	QTY	DESCRIPTION	REMARKS	UNIT PRICE	TOTAL
1	1.00	LOCATABLE MINERALS / MINING CLAIMS-NEW, UNADJUD, ONE OR MORE AUTH NOS / NEW MINING CLAIM PROCESSING FEE \$15 CASES: AMC420456/\$15.00		- n/a -	15.00
2	1.00	LOCATABLE MINERALS / MINING CLAIMS-NEW, UNADJUD, ONE OR MORE AUTH NOS / NEW MINING CLAIM LOCATION FEE \$34 CASES: AMC420456/\$34.00		- n/a -	34.00
3	1.00	LOCATABLE MINERALS / MINING CLAIMS-NEW, UNADJUD, ONE OR MORE AUTH NOS / NEW MINING CLAIM MAINT FEE \$140 CASES: AMC420456/\$140.00		- n/a -	140.00
4	1.00	LOCATABLE MINERALS / MINING CLAIMS-NEW, UNADJUD, ONE OR MORE AUTH NOS / NEW MINING CLAIM MAINT FEE \$140 CASES: AMC420456/\$140.00	<i>Should be NOT NEW</i>	- n/a -	140.00
5	1.00	LOCATABLE MINERALS / MINING CLAIMS-NOT NEW-UNADJUD, ONE AUTH NO. ONLY / MINING CLAIM MONEY RECEIVED CASES: AMC395762/\$40.00	POL (3) NOI (1)	- n/a -	40.00
TOTAL:					\$369.00

PAYMENT INFORMATION			
NOTE: Items will appear on credit card statement as "Bureau of Land Mgmt CO".			
1	AMOUNT:	369.00	POSTMARKED: N/A
	TYPE:	CREDIT CARD	RECEIVED: 12/27/2012
	NAME:	REAVES, ROBERT 23550 S BUMBLE BEE RD MAYER AZ 86333-9533 US	
	CARD NO:	XXXXXXXXXXXXXXXXXX	AUTH CODE: 815385

NAME ON CARD:	ROBERT REAVES
EXPIRES:	10/2014
SIGNATURE:	

REMARKS
TEMP RECEIPT 170740

This receipt was generated by the automated BLM Collections and Billing System and is a paper representation of a portion of the official electronic record contained therein.

NOTICE!!

These documents have been scanned!

Do not place un-scanned documents beneath this notice!

Do not remove this notice from this file!

GPO Jacket No. 560-102
Print Order 61540
Rise Business Services, LLC
Job=AZ15 5/13/2019



Box Number= AZ15042



Claim Begin-End: AMC420456-AMC420456

2 Correspondence



AZ15042-10

AMC420196-AMC421069

**NO
DOCUMENTS
FOUND**

NO DOCUMENTS FOUND
NO DOCUMENTS FOUND

NOTICE!!

These documents have been scanned!

Do not place un-scanned documents beneath this notice!

Do not remove this notice from this file!

GPO Jacket No. 560-102
Print Order 61540
Rise Business Services, LLC
Job=AZ15 5/13/2019



Box Number= AZ15042



Claim Begin-End: AMC420456-AMC420456

3 Transfers



AZ15042-10

AMC420196-AMC421069

**NO
DOCUMENTS
FOUND**

NO DOCUMENTS FOUND
NO DOCUMENTS FOUND

NOTICE!!

These documents have been scanned!

Do not place un-scanned documents beneath this notice!

Do not remove this notice from this file!

GPO Jacket No. 560-102
Print Order 61540
Rise Business Services, LLC
Job=AZ15 5/13/2019



Box Number= AZ15042



Claim Begin-End: AMC420456-AMC420456

4 Miscellaneous



AZ15042-10

AMC420196-AMC421069

**NO
DOCUMENTS
FOUND**

NO DOCUMENTS FOUND
NO DOCUMENTS FOUND

NOTICE!!

These documents have been scanned!

Do not place un-scanned documents beneath this notice!

Do not remove this notice from this file!

GPO Jacket No. 560-102
Print Order 61540
Rise Business Services, LLC
Job=AZ15 5/13/2019



Box Number= AZ15042



Claim Begin-End: AMC420456-AMC420456

5 Annual Filings



AZ15042-10

AMC420196-AMC421069

When Recorded Return Document to:

RON ROBRAN
W. 4160 ST. RD. 20
EAST TROY, WISC.
53120

395761
424574
425094
428903
418496
420456

Check here if this is a change of address.

Telephone: 262-475-7788 CELL.

E-mail address: ALSMITHS81@HOTMAIL.COM

AFFIDAVIT OF PERFORMANCE OF ANNUAL WORK

1. State of Arizona, County of YAVAPAI ss:

2. I (Name) RON ROBRAN

3. Reside at (Address) W. 4160 ST. RD. 20

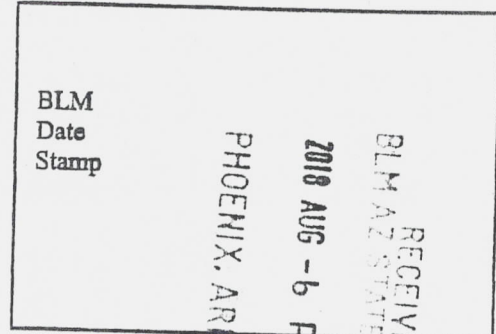

City EAST TROY County WALWORTH

State WI zip 53120 being duly sworn, depose and say that I am a citizen of the United States, more than eighteen years of age, and that all of the facts set forth in this affidavit, subject to the provisions and penalties of 18 U.S.C. 1001 pertaining to the filing of false, fictitious, or fraudulent statements with the United States, are true and correct according to the best of my knowledge, information and belief.

4. Owner's name and address (If not shown in Items 1-3 above).

5. That I am personally acquainted with the mining claim(s). The work and improvements were made by and at the expense of the owner(s) of said claim(s). Said contiguous group of claims, listed on this document, are situated in the

(optional) Mining District; YAVAPAI County, Arizona.

Line No.	AMC NUMBER	CLAIM/SITE NAME	COUNTY RECORDER DATA (if available)	TWP	RNG	SEC
1	395763	YELLOW GOLD	B4974 P980	9 1/2 N	2 E	29
2	424576	YELLOW GOLD B	B4987 P530	9 1/2 N	2 E	29
3	424577	YELLOW GOLD C	B4987 P531	9 1/2 N	2 E	29
4	425095	YELLOW GOLD D	2014-0001388	9 1/2 N	2 E	29
5	395762	RING GOLD	B4974 P981	9 1/2 N	2 E	32
6	428903	RING GOLD B	2014-0043435	9 1/2 N	2 E	32

Form: MCF108
Revised July 2014
Page 1 of 2

ENTERED
AUG 10 2018
BY: RAM

RECEIVED
BLM AZ STATE OFFICE
2018 AUG - 6 P 2:13
PHOENIX, ARIZONA
BLM
Date
Stamp

7	424575	RING GOLD C	B4987 P528	9 1/2 N	ZE	32
8	425094	RING GOLD D	2014-0001389	9 1/2 N	ZE	32
9	418496	RED HILL 1	B4921 P118	9 1/2 N	ZE	29
10	420456	RED HILL 2	B4983 P746	9 1/2 N	ZE	32

6. That between the dates starting at 12 o'clock noon on September 1, 20 17 and ending at 12 o'clock noon on September 1, 20 18 at least \$ 1000 dollars worth of work and improvements were done and performed upon said claim(s) or upon one or more of a contiguous group of claims for the benefit of all, wholly or partly outside of a contiguous group of claims for the benefit of all, not including the location work.

7. That the following persons were employed to perform the work and improvements described herein: RON & SANDY ROBRAN

8. That the work and improvements performed were: ACTIVE MINING & TESTING
ROAD WORK & MAINTENANCE, TRASH CLEANUP

9. Dated: 8/1/18 Signature: Ron Robran

SUBSCRIBED AND SWORN TO before me, a Notary Public, this 1st day of August 2018

By: Ron Robran

Notary Public J. R. Bower

My Commission Expires 12/18/20
state of Wisconsin
County of Walworth

Bureau of Land Management
Arizona State Office
www.blm.gov/az

No. of Claims: _____ x \$10 = _____
Check No.: _____ Init. _____
Receipt No.: 4230462
For BLM Use Only

PRESS FIRMLY TO SEAL

PRESS FIRMLY TO SEAL

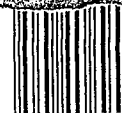

1006

85004

PAID
EAST TROY, WI
53120
AUG 03 18
AMOUNT
\$6.70
R2305K135633-02

PRIORITY[®] ★ MAIL ★

- DATE OF DELIVERY SPECIFIC
 - USPS TRACKING[™] INCLUDED
 - INSURANCE INCLUDED*
 - PICKUP AVAILABLE
- * Domestic only

Expected Delivery Day: 08/06/2018

USPS TRACKING NUMBER



9505 5117 8187 8215 1877 84

RECEIVED
BLM AZ STATE OFFICE
2018 AUG 15 P 2:12
PHOENIX ARIZONA

WHEN USED INTERNATIONALLY,
A CUSTOMS DECLARATION
LABEL MAY BE REQUIRED.

FROM **PRIORITY[®]
★ MAIL ★**



VISIT US AT USPS.COM[®]
ORDER FREE SUPPLIES ONLINE

FROM:

Ron Robran
4160 State Rd 20
East Troy, WI 53120

TO:

United States Dept. of the Interior
Bureau of Land Management
Arizona State Office
1 North Central Avenue
Suite 800
Phoenix AZ 85004-4427
re: Affidavit of Performance

Label 228, March 2016

FOR DOMESTIC AND INTERNATIONAL USE



PS00001000014

EP14F July 2013
OD: 12.5 x 9.5

VISIT US AT USPS.COM[®]
ORDER FREE SUPPLIES ONLINE



This envelope is made from post-consumer waste. Please recycle - again.

This packaging is the property of the U.S. Postal Service[®] and is provided solely for use in sending Priority Mail[®] shipments. Misuse may be a violation of federal law. © 2013 U.S. Postal Service. All rights reserved.

United States Department of the Interior
Bureau of Land Management
 DIV OF LANDS, MINRLS & ENERGY
 ONE N CENTRAL AVE
 PHOENIX, AZ 85004 -4427
 Phone: 602-417-9200

Receipt

No: 4230462

Transaction #: 4345742	
Date of Transaction: 08/08/2018	
CUSTOMER:	
	RON ROBRAN W4160 STATE ROAD 20 EAST TROY, WI 53120-1710 US

LINE #	QTY	DESCRIPTION	REMARKS	UNIT PRICE	TOTAL
1	1.00	LOCATABLE MINERALS / MINING CLAIMS- NOT NEW-UNADJUD, ONE AUTH NO. ONLY / MINING CLAIM MONEY RECEIVED CASES: AMC395763/\$100.00	POL 2018/10 WAV	- n/a -	100.00
TOTAL:					\$100.00

PAYMENT INFORMATION					
1	AMOUNT:	100.00	POSTMARKED:	N/A	
	TYPE:	CHECK	RECEIVED:	08/06/2018	
	CHECK NO:	1822			
	NAME:	ROBRAN, RON W4160 STATE ROAD 20 EAST TROY WI 53120-1710 US			

REMARKS

This receipt was generated by the automated BLM Collections and Billing System and is a paper representation of a portion of the official electronic record contained therein.

UNITED STATES
DEPARTMENT OF THE INTERIOR
BUREAU OF LAND MANAGEMENT

MAINTENANCE FEE WAIVER CERTIFICATION

SEE INSTRUCTIONS ON PAGE 2

166
395761
Amc 424574
Amc 425095
FORM APPROVED
OMB NO. 1004-0114
Expires: January 31, 2020
Amc 418496
Amc 420456

- This small miner waiver is filed for the assessment year beginning on September 1, 2018 and ending on September 1, 2019
- The undersigned and all related parties owned ten or fewer mining claims, mill, or tunnel sites located and maintained on Federal lands in the United States of America on September 1, 2018
- The undersigned have performed the assessment work required by law for each mining claim listed prior to filing this waiver and understand that by filing this form, the undersigned must file an affidavit of assessment work with the Bureau of Land Management (BLM) by the December 30th following the filing of this waiver.
- The undersigned understand that if the assessment work obligation has not yet come due under 30 U.S.C. 28 (for those claims in their first assessment year only), a notice of intent to hold reciting this condition must be recorded by the December 30th following the filing of this waiver.
- The undersigned understand that mill and tunnel sites may also be listed on this waiver and be waived from payment of the maintenance fee, and that a notice of intent to hold for these sites is required to be filed with the BLM by the December 30th following the filing of this waiver.
- The undersigned understand and acknowledge that pursuant to 43 U.S.C. 1212 and 18 U.S.C. 1001, the filing or recording of a false, fictitious, or fraudulent document with the BLM may result in a fine of up to \$250,000, a prison term not to exceed five years, or both.
- The mining claims, mill or tunnel sites for which this waiver from payment of the maintenance fees is requested are:

CLAIM OR SITE NAME	BLM RECORDATION SERIAL NUMBER
1. YELLOW GOLD	395763
2. YELLOW GOLD B	424576
3. YELLOW GOLD C	424577
4. YELLOW GOLD D	425095
5. RING GOLD	395762
6. RING GOLD B	428903
7. RING GOLD C	424575
8. RING GOLD D	425094
9. RED HILL #1	418496
10. RED HILL #2	420456

The owner(s) (claimants) of the above mining claims and sites are:

100% Ron Robran
(Owner's Name - Please Print)
W.4160 ST. RD. 20
(Owner's Mailing Address)

Ron Robran
(Owner's Signature)
EAST TROY WIS 53120
(City) (State) (Zip Code)

100% SANDY ROBRAN
(Owner's Name - Please Print)
W.4160 ST. RD. 20
(Owner's Mailing Address)

* Sandy Robran
(Owner's Signature)
EAST TROY WIS 53120
(City) (State) (Zip Code)

(Owner's Name - Please Print)

(Owner's Mailing Address)

(Owner's Signature)

(City) (State) (Zip Code)

(Owner's Name - Please Print)

(Owner's Mailing Address)

(Owner's Signature)

(City) (State) (Zip Code)

AC 483
ENTERED SEP 04 2018
PB

PHOENIX, ARIZONA
2018 AUG -6 P 2:13
RECEIVED
BLM AT STATE OFFICE

(Continued on page 2)

NW/PB

(Owner's Name - Please Print)	(Owner's Signature)		
(Owner's Mailing Address)	(City)	(State)	(Zip Code)
(Owner's Name - Please Print)	(Owner's Signature)		
(Owner's Mailing Address)	(City)	(State)	(Zip Code)
(Owner's Name - Please Print)	(Owner's Signature)		
(Owner's Mailing Address)	(City)	(State)	(Zip Code)
(Owner's Name - Please Print)	(Owner's Signature)		
(Owner's Mailing Address)	(City)	(State)	(Zip Code)

18 U.S.C. 1001 and 43 U.S.C. 1212 make it a crime for any person knowingly and willfully to make to any department or agency of the United States any false, fictitious or fraudulent statements or representations as to any matter within its jurisdiction.

INSTRUCTIONS

1. This certification is made under the provisions of 43 U.S.C. § 1744 and 30 U.S.C. §28-28k and the regulations thereunder (43 CFR Part 3830).
2. The claimant(s) must fill in the dates in paragraph 1 for the beginning and ending of the assessment year for which this waiver is sought.
3. The claimant(s) must fill in the date in paragraph 2 for the beginning of the assessment year for which this waiver is sought.
4. All claim and site names and BLM serial numbers must be listed for the mining claims, mill sites, and tunnel sites for which the waiver is sought.
5. All owners of the mining claims, mill sites, and tunnel sites and their addresses must be given.
6. This waiver form must be signed by all the claimants or their designated agent, in original form. If an agent is designated, a notarized designation of agent, signed by all of the claimants with proper address given, must be submitted with this waiver.
7. This form must be filed no later than September 1st for the upcoming assessment year in the BLM State Office where the mining claims or sites are recorded, or the waiver cannot be granted by the BLM. (Example: To obtain a waiver for the assessment year 2012, which begins on September 1, 2011, you must qualify for and file for a waiver no later than September 1, 2011, in the proper BLM State Office.)
8. For all mining claims which require assessment work, you must record an affidavit of labor on or before the December 30th immediately following the filing of this waiver. For all other mining claims or sites waived, you must record a notice of intent to hold on or before the December 30th immediately following the filing of this waiver.
9. Mill and tunnel sites may also be listed on this waiver and be waived from payment of the maintenance fee. A notice of intent to hold for these sites is required to be filed by the December 30th following the filing of this waiver.

395 762-763
 108 126
 108 126
 108 126
 108 126
 108 126

FOR OFFICIAL USE ONLY
RECEIVED
BLM STATE OFFICE
PHOENIX, ARIZONA
2010 AUG -6 P 2:13

UNITED STATES
DEPARTMENT OF THE INTERIOR
BUREAU OF LAND MANAGEMENT

MAINTENANCE FEE WAIVER CERTIFICATION

SEE INSTRUCTIONS ON PAGE 2

201
JMC

AMC 395761
418496
420456

FORM APPROVED
OMB NO. 1004-0114

424574
425094
428903

- This small miner waiver is filed for the assessment year beginning on September 1, 2017 and ending on September 1, 2018
- The undersigned and all related parties owned ten or fewer mining claims, mill, or tunnel sites located and maintained on Federal lands in the United States of America on September 1, 2017.
- The undersigned have performed the assessment work required by law for each mining claim listed prior to filing this waiver and understand that by filing this form, the undersigned must file an affidavit of assessment work with the Bureau of Land Management (BLM) by the December 30th following the filing of this waiver.
- The undersigned understand that if the assessment work obligation has not yet come due under 30 U.S.C. 28 (for those claims in their first assessment year only), a notice of intent to hold reciting this condition must be recorded by the December 30th following the filing of this waiver.
- The undersigned understand that mill and tunnel sites may also be listed on this waiver and be waived from payment of the maintenance fee, and that a notice of intent to hold for these sites is required to be filed with the BLM by the December 30th following the filing of this waiver.
- The undersigned understand and acknowledge that pursuant to 43 U.S.C. 1212 and 18 U.S.C. 1001, the filing or recording of a false, fictitious, or fraudulent document with the BLM may result in a fine of up to \$250,000, a prison term not to exceed five years, or both.
- The mining claims, mill or tunnel sites for which this waiver from payment of the maintenance fees is requested are:

CLAIM OR SITE NAME	BLM RECORDATION SERIAL NUMBER
1. Yellow Gold	✓ 395763
2. Yellow Gold B	424576
3. Yellow Gold C	424577
4. Yellow Gold D	425095
5. RING GOLD	395762
6. RING GOLD B	428903
7. RING GOLD C	424575
8. RING GOLD D	425094
9. RED HILL 1	418496
10. RED HILL 2	420456

The owner(s) (claimants) of the above mining claims and sites are:

Rox Robran ✓
 (Owner's Name - Please Print)
 W. 4160 ST. RD. 20
 (Owner's Mailing Address)

Rox Robran
 (Owner's Signature)
 EAST TROY WIS. 53120
 (City) (State) (Zip Code)

SANDY ROBRAN ✓
 (Owner's Name - Please Print)
 W. 4160 ST. RD. 20
 (Owner's Mailing Address)

Sandy Robran
 (Owner's Signature)
 EAST TROY WIS. 53120
 (City) (State) (Zip Code)

(Owner's Name - Please Print)
 (Owner's Mailing Address)

(Owner's Signature)
 (City) (State) (Zip Code)

AC 483
 ENTERED SEP 06 2017
 PB

2017 AUG 15 P 3:03
 BLM RECEIVED
 HOENIG, A ZONA

(Owner's Name - Please Print)
 (Owner's Mailing Address)

(Owner's Signature)
 (City) (State) (Zip Code)

(Continued on page 2)

Mw check
10 EACH

DEPARTMENT OF THE INTERIOR
BUREAU OF LAND MANAGEMENT
MINING CLAIMS

MC Customer Information - With Serial No. and Claim Name
ACTIVE CLAIMS

Admin State: AZ

Geo State: AZ

ROBRAN RON
W4160 STATE ROAD 20
EAST TROY, WI 53120-1710

CUSTOMER ID: 2338607

<u>Serial No.</u>	<u>Claim Name/Number</u>	<u>Lead Serial No.</u>	<u>Disposition</u>
AMC395762	RING GOLD	AMC395761	ACTIVE
AMC395763	YELLOW GOLD	AMC395761	ACTIVE
AMC418496	RED HILL #1	AMC418496	ACTIVE
AMC420456	RED HILL #2	AMC420456	ACTIVE
AMC424575	RING GOLD C	AMC424574	ACTIVE
AMC424576	YELLOW GOLD B	AMC424574	ACTIVE
AMC424577	YELLOW GOLD C	AMC424574	ACTIVE
AMC425094	BING GOLD "D"	AMC425094	ACTIVE
AMC425095	YELLOW GOLD "D"	AMC425094	ACTIVE
AMC428903	RING GOLD "B"	AMC428903	ACTIVE

Number of ACTIVE cases: 10

ROBRAN SANDY
W4160 STATE ROAD 20
EAST TROY, WI 53120-1710

CUSTOMER ID: 2338610

<u>Serial No.</u>	<u>Claim Name/Number</u>	<u>Lead Serial No.</u>	<u>Disposition</u>
AMC395762	RING GOLD	AMC395761	ACTIVE
AMC395763	YELLOW GOLD	AMC395761	ACTIVE
AMC418496	RED HILL #1	AMC418496	ACTIVE
AMC420456	RED HILL #2	AMC420456	ACTIVE
AMC424575	RING GOLD C	AMC424574	ACTIVE
AMC424576	YELLOW GOLD B	AMC424574	ACTIVE
AMC424577	YELLOW GOLD C	AMC424574	ACTIVE
AMC425094	BING GOLD "D"	AMC425094	ACTIVE
AMC425095	YELLOW GOLD "D"	AMC425094	ACTIVE
AMC428903	RING GOLD "B"	AMC428903	ACTIVE

Number of ACTIVE cases: 10

UNITED STATES DEPARTMENT OF THE INTERIOR
BUREAU OF LAND MANAGEMENT

MC NATIONWIDE CLAIMANT LISTING
September 06, 2017

Cust	AZ CLAIMANT	National Total
ROBRAN RON W4160 STATE ROAD 20 EAST TROY, WI 53120-1710	10	10
ROBRAN SANDY W4160 STATE ROAD 20 EAST TROY, WI 53120-1710	10	10

When Recorded Return Document:

KON ROBRAN
W. 4160 ST RD 20
EAST TROY, WIS.
53120

395761

424574

425094

428903

418496

420456

Check here if this is a change of address.

Telephone: 262-642-7891 CELL 262-745-2414

E-mail address: glsmitas81@hotmail.com

AFFIDAVIT OF PERFORMANCE OF ANNUAL WORK

1. State of Arizona, County of YAVAPAI ss:

2. I (Name) KON ROBRAN

3. Reside at (Address) W. 4160 ST RD 20

City EAST TROY County WALWORTH

State WI Zip 53120 being duly sworn, depose and say that I am a citizen of the United States, more than eighteen years of age, and that all of the facts set forth in this affidavit, subject to the provisions and penalties of 18 U.S.C. 1001 pertaining to the filing of false, fictitious, or fraudulent statements with the United States, are true and correct according to the best of my knowledge, information and belief.

4. Owner's name and address (if not shown in items 1-3 above) _____

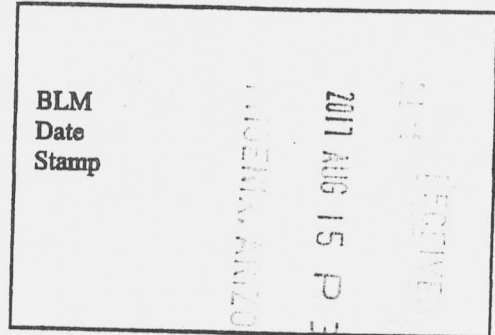

5. That I am personally acquainted with the mining claim(s). The work and improvements were made by and at the expense of the owner(s) of said claim(s). Said contiguous group of claims, listed on this document, are situated in the

(optional) Mining District; YAVAPAI County, Arizona.

Line No.	AMC NUMBER	CLAIM/SITE NAME	COUNTY RECORDER DATA (if available)	TWP	RNG	SEC
1	395763	YELLOW GOLD	B4974 P 980	9 1/2 N	2E	29
2	424576	YELLOW GOLD "B"	B4987 P 530	9 1/2 N	2E	29
3	424577	YELLOW GOLD "C"	B4987 P 531	9 1/2 N	2E	29
4	425095	YELLOW GOLD "D"	2014-0001388	9 1/2 N	2E	29
5	395762	RING GOLD	B4974 P 981	9 1/2 N	2E	32
6	428903	RING GOLD "B"	2014-0043435	9 1/2 N	2E	32

Form: MCF108
Revised July 2014
Page 1 of 2

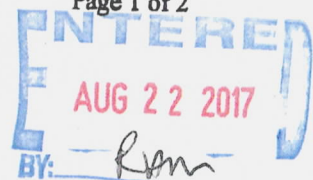

BLM
Date
Stamp

2017 AUG 15

7	424575	RINGGOLD C	B4987 P528	9 1/2	2E	32
8	425094	RINGGOLD D	2014-0001389	9 1/2	2E	32
9	418496	RED HILL 1	B4921 P118	9 1/2	2E	29
10	420456	RED HILL 2	B4983 P746	9 1/2	2E	32

6. That between the dates starting at 12 o'clock noon on September 1, 2016 and ending at 12 o'clock noon on September 1, 2017 at least \$ 1,000.00 dollars worth of work and improvements were done and performed upon said claim(s) or upon one or more of a contiguous group of claims for the benefit of all, wholly or partly outside of a contiguous group of claims for the benefit of all, not including the location work.

7. That the following persons were employed to perform the work and improvements described herein: ROU & SANDY ROBRAN

8. That the work and improvements performed were: ACTIVE MINING & TESTING ROAD WORK - MAINTENANCE, TRASH CLEANUP

9. Dated: 8-8-17 Signature: Rou Robran

SUBSCRIBED AND SWORN TO before me, a Notary Public, this 8 day of August 2017

By: SANDRA J. PERSINGER

Notary Public Sandra J. Persinger

My Commission Expires 7-18-18

Bureau of Land Management
Arizona State Office
www.blm.gov/az

No. of Claims: 10 x \$10 = 100
Check No.: 1636 Init. [Signature]
Receipt No.: 39140308
For BLM Use Only

Form: MCF108
Revised July 2014
Page 2 of 2

United States Department of the Interior
Bureau of Land Management
 DIV OF LANDS, MINRLS & ENERGY
 ONE N CENTRAL AVE
 PHOENIX, AZ 85004 -4427
 Phone: 602-417-9200

Receipt

No: 3940308

Transaction #: 4049964	
Date of Transaction: 08/16/2017	
CUSTOMER:	
RON ROBRAN W4160 STATE ROAD 20 EAST TROY, WI 53120-1710 US	

LINE #	QTY	DESCRIPTION	REMARKS	UNIT PRICE	TOTAL
1	1.00	LOCATABLE MINERALS / MINING CLAIMS- NOT NEW-UNADJUD, ONE AUTH NO. ONLY / MINING CLAIM MONEY RECEIVED CASES: AMC395763/\$100.00	POL 2017/10 WAV	- n/a -	100.00
TOTAL:					\$100.00

PAYMENT INFORMATION			
1	AMOUNT:	100.00	POSTMARKED: 08/09/2017
	TYPE:	CHECK	RECEIVED: 08/15/2017
	CHECK NO:	1636	
	NAME:	ROBRAN, SANDRA J W4160 STATE ROAD 20 EAST TROY WI 53120-1710 US	

REMARKS

This receipt was generated by the automated BLM Collections and Billing System and is a paper representation of a portion of the official electronic record contained therein.

UNITED STATES
DEPARTMENT OF THE INTERIOR
BUREAU OF LAND MANAGEMENT

237
JMC

395761 424574
418496 425094
420456 428903

MAINTENANCE FEE WAIVER CERTIFICATION

FORM APPROVED
OMB NO. 1004-0114
Expires: October 31, 2016

SEE INSTRUCTIONS ON PAGE 2

- This small miner waiver is filed for the assessment year beginning on September 1, 2016 and ending on September 1, 2017.
- The undersigned and all related parties owned ten or fewer mining claims, mill, or tunnel sites located and maintained on Federal lands in the United States of America on September 1, 2016.
- The undersigned have performed the assessment work required by law for each mining claim listed prior to filing this waiver and understand that by filing this for the undersigned must file an affidavit of assessment work with the Bureau of Land Management (BLM) by the December 30th following the filing of this waiver.
- The undersigned understand that if the assessment work obligation has not yet come due under 30 U.S.C. 28 (for those claims in their first assessment year only), a notice of intent to hold reciting this condition must be recorded by the December 30th following the filing of this waiver.
- The undersigned understand that mill and tunnel sites may also be listed on this waiver and be waived from payment of the maintenance fee, and that a notice of intent to hold for these sites is required to be filed with the BLM by the December 30th following the filing of this waiver.
- The undersigned understand and acknowledge that pursuant to 43 U.S.C. 1212 and 18 U.S.C. 1001, the filing or recording of a false, fictitious, or fraudulent document with the BLM may result in a fine of up to \$250,000, a prison term not to exceed five years, or both.
- The mining claims, mill or tunnel sites for which this waiver from payment of the maintenance fees is requested are:

CLAIM OR SITE NAME	BLM RECORDATION SERIAL NUMBER
1. YELLOW GOLD	395763 ✓
2. YELLOW GOLD B	424576
3. YELLOW GOLD C	424577
4. YELLOW GOLD D	425095
5. RING GOLD	395762
6. RING GOLD B	428903
7. RING GOLD C	424575
8. RING GOLD D	425094
9. RED HILL 1	418496
10. RED HILL 2	420456

The owner(s) (claimants) of the above mining claims and sites are:

RON ROBRAN
(Owner's Name - Please Print)
W. 4160 ST. RD. 20
(Owner's Mailing Address)

Ron Robran
(Owner's Signature)
EAST TROY WI 53120
(City) (State) (Zip Code)

SANDY ROBRAN
(Owner's Name - Please Print)
W. 4160 ST RD 20
(Owner's Mailing Address)

Sandy Robran
(Owner's Signature)
EAST TROY WI 53120
(City) (State) (Zip Code)

(Owner's Name - Please Print)
(Owner's Mailing Address)

(Owner's Signature)
(City) (State) (Zip Code)

(Owner's Name - Please Print)

(Owner's Signature)

ENTERED
483
SEP 01 2016
BY: JMC

PHOENIX, ARIZONA
2016 AUG 12 P 3 09
RECEIVED
BLM AZ STATE OFFICE

NW

When Recorded Return Document to:

RON ROBRAN
W. 4160 ST. RD. 20
EAST TROY, WIS. 53120

395761
418496
420456
424574
425094
428903

Check here if this is a change of address.

Telephone: 262-642-7891

E-mail address: alsmiths81@hotmail.com

AFFIDAVIT OF PERFORMANCE OF ANNUAL WORK

1. State of Arizona, County of YAVAPAI ss:

2. I (Name) RON ROBRAN

3. Reside at (Address) W. 4160 ST RD 20

City EAST TROY County WALWORTH

State WI Zip 53120 being duly sworn, depose and say that I am a citizen of the United States, more than eighteen years of age, and that all of the facts set forth in this affidavit, subject to the provisions and penalties of 18 U.S.C. 1001 pertaining to the filing of false, fictitious, or fraudulent statements with the United States, are true and correct according to the best of my knowledge, information and belief.

4. Owner's name and address (if not shown in Items 1-3 above).

5. That I am personally acquainted with the mining claim(s). The work and improvements were made by and at the expense of the owner(s) of said claim(s). Said contiguous group of claims, listed on this document, are situated in the

(optional) Mining District; YAVAPAI County, Arizona.

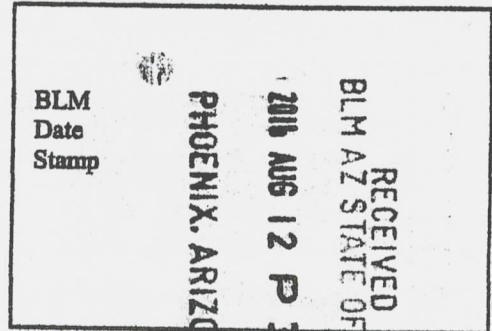

Line No.	AMC NUMBER	CLAIM/SITE NAME	COUNTY RECORDER DATA (if available)	TWP	RNG	SEC
1	395763	YELLOW GOLD	B4974 P980	9 1/2 N	2 E	29
2	424576	YELLOW GOLD B	B4987 P 530	9 1/2 N	2 E	29
3	424577	YELLOW GOLD C	B4987 P 531	9 1/2 N	2 E	29
4	425095	YELLOW GOLD D	2014-0001388	9 1/2 N	2 E	29
5	395762	RING GOLD	B4974 P981	9 1/2 N	2 E	32
6	428903	RING GOLD B	2014-0043435	9 1/2 N	2 E	32

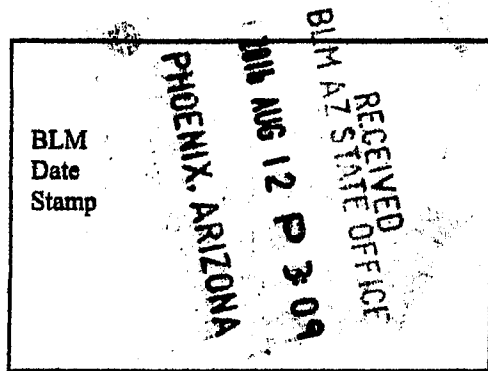

7	424575	RING GOLD C	B4987 P 528	9 1/2 N	2 E	32
8	425094	RING GOLD D	2014-0001389	9 1/2 N	2 E	32
9	418496	RED HILL 1	B4921 P 118	9 1/2 N	2 E	29
10	420456	RED HILL 2	B4983 P 746	9 1/2 N	2 E	32

6. That between the dates starting at 12 o'clock noon on September 1, 20 15 and ending at 12 o'clock noon on September 1, 20 16 at least \$ 1000.00 dollars worth of work and improvements were done and performed upon said claim(s) or upon one or more of a contiguous group of claims for the benefit of all, wholly or partly outside of a contiguous group of claims for the benefit of all, not including the location work.

7. That the following persons were employed to perform the work and improvements described herein: RON = SANDY ROBRAN

8. That the work and improvements performed were: ROAD WORK = MAINTENANCE
ACTIVE MINING, TRASH CLEAN-UP

9. Dated: 8-4-16 Signature: [Signature]

SUBSCRIBED AND SWORN TO before me, a Notary Public, this 4 day of August 2016

By: [Signature]

Notary Public SANDRA J. PERSINGER

My Commission Expires 7-18-18

Bureau of Land Management
Arizona State Office
www.blm.gov/az

No. of Claims:	<u>10</u>	x \$10 =	<u>100</u>
Check No.:	<u>1437</u>	Init.	<u>[Init]</u>
Receipt No.:	<u>31630142</u>		
For BLM Use Only			

United States Department of the Interior
Bureau of Land Management
 DIV OF LANDS, MINRLS & ENERGY
 ONE N CENTRAL AVE
 PHOENIX, AZ 85004 -4427
 Phone: 602-417-9200

Receipt

No: 3630142

Transaction #: 3733926	
Date of Transaction: 08/15/2016	
CUSTOMER:	
RON ROBRAN W4160 STATE ROAD 20 EAST TROY, WI 53120-1710 US	

LINE #	QTY	DESCRIPTION	REMARKS	UNIT PRICE	TOTAL
1	1.00	LOCATABLE MINERALS / MINING CLAIMS- NOT NEW-UNADJUD, ONE AUTH NO. ONLY / MINING CLAIM MONEY RECEIVED CASES: AMC395763/\$100.00	POL 2016/10 WAV	- n/a -	100.00
TOTAL:					\$100.00

PAYMENT INFORMATION					
1	AMOUNT:	100.00	POSTMARKED:	08/09/2016	
	TYPE:	CHECK	RECEIVED:	08/12/2016	
	CHECK NO:	1437			
	NAME:	ROBRAN, SANDRA W4160 STATE ROAD 20 EAST TROY WI 53120-1710 US			

REMARKS

This receipt was generated by the automated BLM Collections and Billing System and is a paper representation of a portion of the official electronic record contained therein.

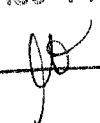
ENTERED
 AUG 17 2016
 BY: 

Ron Robran
W4160 State Rd 20
East Troy WI 53120

7007 2560 0003 0222 7078

PLACE STICKER AT TOP OF ENVELOPE TO THE RIGHT
OF THE RETURN ADDRESS, FOLD AT DOTTED LINE

CERTIFIED MAIL™

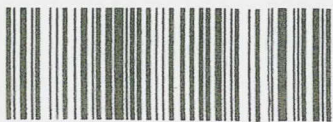

7007 2560 0003 0222 7078



1000



85004

U.S. POSTAGE
PAID
EAST TROY, WI
53120
AUG 09, 16
AMOUNT

\$4.45

R2305K135633-07

RECEIVED
BLM AZ STATE OFFICE
2016 AUG 12 P 3:09
PHOENIX, ARIZONA

United States Dept. of the Interior
Bureau of Land Management
Land / Recreation Planning
One N. Central Ave.
Phoenix, AZ 85004-2203



UNITED STATES
DEPARTMENT OF THE INTERIOR
BUREAU OF LAND MANAGEMENT
MAINTENANCE FEE WAIVER CERTIFICATION

194

395 761
424574
FORM APPROVED
OMB NO. 1004-0114
Expires: October 31, 2016
425094

SEE INSTRUCTIONS ON PAGE 2

- This small miner waiver is filed for the assessment year beginning on September 1, 2015 and ending on September 1, 2016
- The undersigned and all related parties owned ten or fewer mining claims, mill, or tunnel sites located and maintained on Federal lands in the United States of America on September 1, 2015.
- The undersigned have performed the assessment work required by law for each mining claim listed prior to filing this waiver and understand that by filing this form, the undersigned must file an affidavit of assessment work with the Bureau of Land Management (BLM) by the December 30th following the filing of this waiver.
- The undersigned understand that if the assessment work obligation has not yet come due under 30 U.S.C. 28 (for those claims in their first assessment year only), a notice of intent to hold reciting this condition must be recorded by the December 30th following the filing of this waiver.
- The undersigned understand that mill and tunnel sites may also be listed on this waiver and be waived from payment of the maintenance fee, and that a notice of intent to hold for these sites is required to be filed with the BLM by the December 30th following the filing of this waiver.
- The undersigned understand and acknowledge that pursuant to 43 U.S.C. 1212 and 18 U.S.C. 1001, the filing or recording of a false, fictitious, or fraudulent document with the BLM may result in a fine of up to \$250,000, a prison term not to exceed five years, or both.
- The mining claims, mill or tunnel sites for which this waiver from payment of the maintenance fees is requested are:

428903
418496
420456

CLAIM OR SITE NAME	BLM RECORDATION SERIAL NUMBER
1. Yellow Gold	395763 ✓
2. Yellow Gold B	424576
3. Yellow Gold C	424577
4. Yellow Gold D	425095
5. Ring Gold	395762
6. Ring Gold B	428903
7. Ring Gold C	424575
8. Ring Gold D	425094
9. Red Hill 1	418496
10. Red Hill 2	420456

The owner(s) (claimants) of the above mining claims and sites are:

Rox Robran
(Owner's Name - Please Print)
W. 4160 ST RD 20
(Owner's Mailing Address)

Rox Robran
(Owner's Signature)
EAST TROY WI 53120
(City) (State) (Zip Code)

Sandy Robran
(Owner's Name - Please Print)
W. 4160 ST RD 20
(Owner's Mailing Address)

Sandy Robran
(Owner's Signature)
EAST TROY WI 53120
(City) (State) (Zip Code)

(Owner's Name - Please Print)
(Owner's Mailing Address)

(Owner's Signature)
(City) (State) (Zip Code)

(Owner's Name - Please Print)
(Owner's Mailing Address)

(Owner's Signature)
(City) (State) (Zip Code)

(Continued on page 2)

ENTERED
SEP 03 2015
BY: [Signature]

RECEIVED
BLM AZ STATE OFFICE
2015 AUG 6 P 3:04
PHOENIX, ARIZONA

NWV
9/3/2015
[Signature]

When Recorded Return Document to:

RON ROBRAN
W. 4160 ST. RD. 20
EAST TROY, WIS. 53120

395761
424574
425094
428903
418496
420456

Check here if this is a change of address.

Telephone: _____

E-mail address: _____

AFFIDAVIT OF PERFORMANCE OF ANNUAL WORK

1. State of Arizona, County of YAVAPAI ss:

2. I (Name) RON ROBRAN

3. Reside at (Address) W. 4160 ST. RD 20

City EAST TROY County WALWORTH

RECEIVED
BLM AZ DISTRICT OFFICE
2015 AUG -6 P 3:04
PHOENIX, ARIZONA
BLM
Date
Stamp

State WI Zip 53120 being duly sworn, depose and say that I am a citizen of the United States, more than eighteen years of age, and that all of the facts set forth in this affidavit, subject to the provisions and penalties of 18 U.S.C. 1001 pertaining to the filing of false, fictitious, or fraudulent statements with the United States, are true and correct according to the best of my knowledge, information and belief.

4. Owner's name and address (If not shown in Items 1-3 above). _____

5. That I am personally acquainted with the mining claim(s). The work and improvements were made by and at the expense of the owner(s) of said claim(s). Said contiguous group of claims, listed on this document, are situated in the

(optional) Mining District: YAVAPAI County, Arizona.

Line No.	AMC NUMBER	CLAIM/SITE NAME	COUNTY RECORDER DATA (If available)	TWP	RNG	SEC
1	395763	Yellow Gold	B4974 P980	9 1/2 N	2 E	29
2	424576	Yellow Gold B	B4987 P 530	9 1/2 N	2 E	29
3	424577	Yellow Gold C	B4987 P 531	9 1/2 N	2 E	29
4	425095	Yellow Gold D	2014-0001388	9 1/2 N	2 E	29
5	395762	RING GOLD	B4974 P981	9 1/2 N	2 E	32
6	418903	RING GOLDB	2014-0043435	9 1/2 N	2 E	32

Ran

RECEIVED
2015 AUG - 6 P 3: 0
PHOENIX, ARIZONA

BLM
Date
Stamp

7	424575	RING Gold C	B4987 P528	9/2 N	2 E	32
8	425094	RING Gold D	2014-0001389	9/2 N	2 E	32
9	418496	RED HILL 1	B4921 P118	9/2 N	2 E	29
10	420456	RED HILL 2	B4933 P 746	9/2 N	2 E	32

6. That between the dates starting at 12 o'clock noon on September 1, 20 14 and ending at 12 o'clock noon on September 1, 20 15 at least \$ 1200.00 dollars worth of work and improvements were done and performed upon said claim(s) or upon one or more of a contiguous group of claims for the benefit of all, wholly or partly outside of a contiguous group of claims for the benefit of all, not including the location work.

7. That the following persons were employed to perform the work and improvements described herein: _____
RON ROBRAN & SANDY ROBRAN

8. That the work and improvements performed were: ACTIVE MINING, ROAD WORK/MAINTENANCE, TRASH CLEAN-UP

9. Dated: 7/29/15 Signature: Ron Robran

SUBSCRIBED AND SWORN TO before me, a Notary Public, this 29 day of July 20 15

By: Sandra J. Persinger

Notary Public SANDRA J. PERSINGER

My Commission Expires 7-28-18

Bureau of Land Management
 Arizona State Office
www.blm.gov/az

No. of Claims: 10 x \$10 = 100
 Check No.: 19193 Init. YML
 Receipt No.: 5391174
 For BLM Use Only

Ron Robran
W4160 State Rd 20
East Troy WI 53120

CERTIFIED MAIL

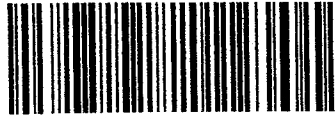

7014 2120 0004 1801 3073



1000

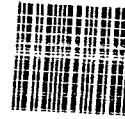

85004

U.S. POSTAGE
PAID
EAST TROY, MI
05122
JUL 31 2015
AMOUNT

\$4.65
00069275-07

RECEIVED
DLM ARIZONA OFFICE

2015 AUG -6 P 3:05

PHOENIX, ARIZONA

Bureau of Land Management
Arizona State Office
1 North Central Avenue
Suite 800
Phoenix, AZ 85004-4427

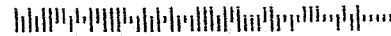

United States Department of the Interior
Bureau of Land Management
 LANDS/RECREATION & PLANNING
 ONE N CENTRAL AVE
 PHOENIX, AZ 85004 -2203
 Phone: 602-417-9200

Receipt

No: 3361176

Transaction #: 3459172	
Date of Transaction: 08/07/2015	
CUSTOMER:	
RON ROBRAN W4160 STATE ROAD 20 EAST TROY, WI 53120-1710 US	

LINE #	QTY	DESCRIPTION	REMARKS	UNIT PRICE	TOTAL
1	1.00	LOCATABLE MINERALS / MINING CLAIMS- NOT NEW-UNADJUD, ONE AUTH NO. ONLY / MINING CLAIM MONEY RECEIVED CASES: AMC395763/\$100.00	POL 2015/10 WAV	- n/a -	100.00
TOTAL:					\$100.00

PAYMENT INFORMATION					
1	AMOUNT:	100.00	POSTMARKED:	07/31/2015	
	TYPE:	CHECK	RECEIVED:	08/06/2015	
	CHECK NO:	19193			
	NAME:	ROBRAN, RONALD E W4160 STATE ROAD 20 EAST TROY WI 53120-1710 US			

REMARKS

This receipt was generated by the automated BLM Collections and Billing System and is a paper representation of a portion of the official electronic record contained therein.

UNITED STATES
DEPARTMENT OF THE INTERIOR
BUREAU OF LAND MANAGEMENT

MAINTENANCE FEE WAIVER CERTIFICATION

266

HTIL 395761 420456
424574 425094
418496

RECEIVED DISTRICT OFFICE

FORM APPROVED
OMB NO. 1004-0114
Expires: October 31, 2016

SEE INSTRUCTIONS ON PAGE 2

- This small miner waiver is filed for the assessment year beginning on September 1, 2014 and ending on September 1, 2015
- The undersigned and all related parties owned ten or fewer mining claims, mill, or tunnel sites located and maintained on Federal lands in the United States of America on September 1, 2014
- The undersigned have performed the assessment work required by law for each mining claim listed prior to filing this waiver and understand that by filing this form, the undersigned must file an affidavit of assessment work with the Bureau of Land Management (BLM) by the December 30th following the filing of this waiver.
- The undersigned understand that if the assessment work obligation has not yet come due under 30 U.S.C. 28 (for those claims in their first assessment year only), a notice of intent to hold reciting this condition must be recorded by the December 30th following the filing of this waiver.
- The undersigned understand that mill and tunnel sites may also be listed on this waiver and be waived from payment of the maintenance fee, and that a notice of intent to hold for these sites is required to be filed with the BLM by the December 30th following the filing of this waiver.
- The undersigned understand and acknowledge that pursuant to 43 U.S.C. 1212 and 18 U.S.C. 1001, the filing or recording of a false, fictitious, or fraudulent document with the BLM may result in a fine of up to \$250,000, a prison term not to exceed five years, or both.
- The mining claims, mill or tunnel sites for which this waiver from payment of the maintenance fees is requested are:

CLAIM OR SITE NAME	BLM RECORDATION SERIAL NUMBER
1. Yellow Gold	✓ 395763
2. Yellow Gold B	424576
3. Yellow Gold C	424577
4. Yellow Gold D	425095
5. RING GOLD	395762
6. RING GOLD B	428903 NEW AMCL (old claim closed)
7. RING GOLD C	424575
8. RING GOLD D	425094
9. RED HILL #1	418496
10. RED HILL #2	420456

The owner(s) (claimants) of the above mining claims and sites are:

RON ROBRAN
(Owner's Name - Please Print)
W. 4160 ST. RD 20
(Owner's Mailing Address)

Ron Robran
(Owner's Signature)
EAST TROY WI 53120
(City) (State) (Zip Code)

SANDRA ROBRAN
(Owner's Name - Please Print)
W. 4160 ST. RD. 20
(Owner's Mailing Address)

Sandra Robran
(Owner's Signature)
EAST TROY WI 53120
(City) (State) (Zip Code)

(Owner's Name - Please Print)

(Owner's Signature)

(Owner's Mailing Address)

(City) (State) (Zip Code)

(Owner's Name - Please Print)

(Owner's Signature)

(Owner's Mailing Address)

(City) (State) (Zip Code)

(Continued on page 2)

ENTERED
SEP 10 2014
BY: RM

2014 AUG 20 A 9: 27
RECEIVED DISTRICT OFFICE
PHOENIX, AZ

NW
9/22/2014

(Owner's Name - Please Print)	(Owner's Signature)
(Owner's Mailing Address)	(City) (State) (Zip Code)
(Owner's Name - Please Print)	(Owner's Signature)
(Owner's Mailing Address)	(City) (State) (Zip Code)
(Owner's Name - Please Print)	(Owner's Signature)
(Owner's Mailing Address)	(City) (State) (Zip Code)
(Owner's Name - Please Print)	(Owner's Signature)
(Owner's Mailing Address)	(City) (State) (Zip Code)

18 U.S.C. 1001 and 43 U.S.C. 1212 make it a crime for any person knowingly and willfully to make to any department or agency of the United States any false, fictitious or fraudulent statements or representations as to any matter within its jurisdiction.

INSTRUCTIONS

1. This certification is made under the provisions of 43 U.S.C. § 1744 and 30 U.S.C. §28-28k and the regulations thereunder (43 CFR Part 3830).
2. The claimant(s) must fill in the dates in paragraph 1 for the beginning and ending of the assessment year for which this waiver is sought.
3. The claimant(s) must fill in the date in paragraph 2 for the beginning of the assessment year for which this waiver is sought.
4. All claim and site names and BLM serial numbers must be listed for the mining claims, mill sites, and tunnel sites for which the waiver is sought.
5. All owners of the mining claims, mill sites, and tunnel sites and their addresses must be given.
6. This waiver form must be signed by all the claimants or their designated agent, in original form. If an agent is designated, a notarized designation of agent, signed by all of the claimants with proper address given, must be submitted with this waiver.
7. This form must be filed no later than September 1st for the upcoming assessment year in the BLM State Office where the mining claims or sites are recorded, or the waiver cannot be granted by the BLM. (Example: To obtain a waiver for the assessment year 2012, which begins on September 1, 2011, you must qualify for and file for a waiver no later than September 1, 2011, in the proper BLM State Office.)
8. For all mining claims which require assessment work, you must record an affidavit of labor on or before the December 30th immediately following the filing of this waiver. For all other mining claims or sites waived, you must record a notice of intent to hold on or before the December 30th immediately following the filing of this waiver.
9. Mill and tunnel sites may also be listed on this waiver and be waived from payment of the maintenance fee. A notice of intent to hold for these sites is required to be filed by the December 30th following the filing of this waiver.

RECEIVED
 BLM AZ STATE OFFICE
 2014 AUG 20 A 9:27
 PHOENIX, AZ

FOR OFFICIAL USE ONLY

DEAR BLM,

YOU RECENTLY RECEIVED OUR AFFIDAVIT OF PERFORMANCE OF ANNUAL WORK AND MAINTENANCE FEE WAIVER CERT. I HAVE REALIZED MAINTENANCE FEE WAIVER CERT. WAS FILLED OUT ON EXPIRED FORM. ENCLOSED IS WAIVER ON CORRECT FORM.

SINCERELY,

Al Smith

CELL: 262-745-9197

EMAIL: ALSMITTS81@HOTMAIL.COM

RECEIVED
PHOENIX DISTRICT OFFICE
2014 AUG 18 PM 1:31
BUREAU OF LAND MANAGEMENT
PHOENIX, AZ

RECEIVED
BLM AZ SITE OFFICE
2014 AUG 20 A 9:27
PHOENIX, AZ

+

UNITED STATES
DEPARTMENT OF THE INTERIOR
BUREAU OF LAND MANAGEMENT

COLLECTION TRANSMITTAL

TO:
PHOENIX DISTRICT OFFICE (LLAZP00000)
21605 N 7TH AVE
PHOENIX AZ 85027
(623)580-5500

FROM:
PHOENIX DISTRICT OFFICE (LLAZP01000)
21605 N. 7TH AVENUE
PHOENIX AZ 85027 - 0000
(623)580-5500

CHECKS

REMITTER	CHECK NUMBER	AMOUNT
RON ROBRAN FARMS LLC	19077	10.00

REMARKS
SHOULD HAVE GONE TO STATE OFFICE

08/18/2014
(Date)

DEBORAH E MORRELL
(Signed)

RECEIVED
BLM, AZ STATE OFFICE
2014 AUG 20 A 9:26
PHOENIX, AZ

428903

RECEIVED
PHOENIX DISTRICT OFFICE
2014 AUG 18 PM 1:37
BUREAU OF LAND MANAGEMENT
PHOENIX, AZ

NOTICE OF INTENTION TO HOLD MINING CLAIMS/SITES

When Recorded Return Document to:

KON ROBRAN
W. 4160 ST. RD 20
EAST TROY, WI. 53120

RECEIVED
BLM, AZ STATE OFFICE
2014 AUG 20 A 9:27
PHOENIX, AZ
BLM
Date
Stamp

Check here if this is a change of address.

Telephone: 262-745-9197

E-mail Address ALSMITHS81@HotMail.com

I (We) intend to hold the claims(s) and/or site(s) listed below for the calendar year 2015, and I (We) have filed or will file a Notice of Intent to Hold in the county where the claim (s) is located.

Reason for filing a Notice of Intent to Hold instead of an assessment work filing (check one):

- Maintenance fee was paid to maintain claim(s) during this assessment year.
- Mill or tunnel sites.
- Claim(s) was located during the current assessment year.
- BLM has deferred assessment work (attach copy of decision granting deferment, or pending petition for deferment including date petition was filed.)

Line No.	AMC NUMBER	CLAIM/SITE NAME	COUNTY RECORDER DATA (If available)	TWP	RNG	SEC
1	428903	RING-GOLDB		9 1/2 N	2 E	32
2						
3						
4						
5						
6						
7						
8						
9						
10						

ENTERED
AUG 27 2014
[Signature]

NOTICE OF INTENTION TO HOLD MINING CLAIMS/SITES
page 2

RECEIVED
BLM ARIZONA STATE OFFICE
2014 AUG 20 A 9:27
PHOENIX, AZ
BLM
Date
Stamp

1. State of Arizona, County of YAVAPAI
2. I (Name) RON ROBRAN, Sandy Robran
3. Reside at (Address) W. 4160 ST, RD 20
City EAST TROY County Walworth State WI Zip 53120 being duly sworn, depose and say that I am a citizen of the United States, more than eighteen years of age, that all of the facts set forth in this notice, subject to the provisions and penalties of 18 U.S.C. 1001 pertaining to the filing of false, fictitious, or fraudulent statements with the United States, are true and correct according to the best of my knowledge, information and belief.
4. Owner's name and address (If not shown in Items 1-3 above). _____

5. Dated: 8-13-14 Signature: Ron Robran Sandy Robran 8-13-14

Bureau of Land Management
Arizona State Office
www.az.blm.gov

No. of Claims: 1 x \$10 = \$10.00
Check No: 19077 Init. AA
Receipt No.: 3108003
For BLM Use Only

United States Department of the Interior
Bureau of Land Management
 LANDS/RECREATION & PLANNING
 ONE N CENTRAL AVE
 PHOENIX, AZ 85004 -2203
 Phone: 602-417-9200

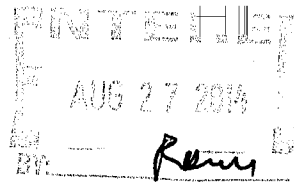

Receipt

No: 3108003

Transaction #: 3199665	
Date of Transaction: 08/21/2014	
CUSTOMER:	
RON ROBRAN W4160 STATE ROAD 20 EAST TROY, WI 53120-1710 US	

LINE #	QTY	DESCRIPTION	REMARKS	UNIT PRICE	TOTAL
1	1.00	LOCATABLE MINERALS / MINING CLAIMS-NOT NEW-UNADJUD, ONE AUTH NO. ONLY / MINING CLAIM MONEY RECEIVED CASES: AMC395763/\$10.00	MAINT FEE WAIVER (1) 2015 / NOI (1) 2014	- n/a -	10.00
TOTAL:					\$10.00

PAYMENT INFORMATION					
1	AMOUNT:	10.00	POSTMARKED:	08/13/2014	
	TYPE:	CHECK	RECEIVED:	08/20/2014	
	CHECK NO:	19077			
	NAME:	ROBRAN, RONALD E W4160 STATE ROAD 20 EAST TROY WI 53120-1710 US			

REMARKS	
ALL CORRESPONDENCE OR ANNUAL FILINGS FOR MINING CLAIMS SHOULD BE SUBMITTED TO THE BLM AZ STATE OFFICE. SEE TOP OF RECEIPT FOR ADDRESS.	

This receipt was generated by the automated BLM Collections and Billing System and is a paper representation of a portion of the official electronic record contained therein.

RT 276 1 D
ST 2.2 8540
08.20

earthsmart
FedEx carbon-neutral
envelope shipping

2014 AUG 20 A 9:27

PHOENIX, AZ

FedEx
TRK 8034 0720 8540
0215

WED - 20 AUG 10:30A
PRIORITY OVERNIGHT

85004
AZ-US
PHX

98 ZSYA

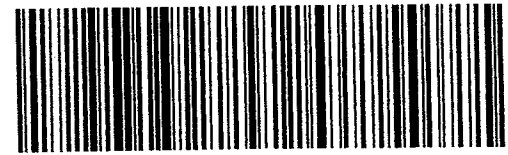

FID 399350 19AUG14 LUFA 522C1/ECF2/6500

Express

00084
00100

FedEx Package Express US Airbill
FedEx Tracking Number 8034 0720 8540

1 From
Date 8-19-14
Sender's Name Bureau of Land Management Phone 480 590-5500
Company BUREAU OF LAND MANAGEMENT
Address 21405 N 27th Ave Dept./Floor/Suite/Room
City PHOENIX State AZ ZIP 85027-8827

2 Your Internal Billing Reference

3 To
Recipient's Name Annaliese Houston Phone 408 977 9200
Company BLM - State Office
Address One North Central Ave
Address Suite 500
City Phoenix State AZ ZIP 85004-4437

HOLD Weekday
FedEx location address
REQUIRED NOT available for
FedEx First Overnight.
HOLD Saturday
FedEx location address
REQUIRED Available ONLY for
FedEx Priority Overnight and
FedEx 2Day to select locations.

0109888709



8034 0720 8540

4 Express Package Service * To most locations. Packages up to 150 lbs. For packages over 50 lbs, see the FedEx Express Freight US Airbill.

NOTE: Service order has changed. Please select carefully.

Next Business Day
 FedEx First Overnight
 Earliest next business morning delivery to select locations. Friday shipments will be delivered on Monday unless SATURDAY Delivery is selected.
 FedEx Priority Overnight
 Next business morning. Friday shipments will be delivered on Monday unless SATURDAY Delivery is selected.
 FedEx Standard Overnight
 Next business afternoon. Saturday Delivery NOT available.

2 or 3 Business Days
 FedEx 2Day A.M.
 Second business morning. Saturday Delivery NOT available.
 FedEx 2Day
 Second business afternoon. Thursday shipments will be delivered on Monday unless SATURDAY Delivery is selected.
 FedEx Express Saver
 Third business day. Saturday Delivery NOT available.

5 Packaging * Declared value limit \$500.
 FedEx Envelope* FedEx Pak* FedEx Box FedEx Tube Other

6 Special Handling and Delivery Signature Options
 SATURDAY Delivery
 NOT available for FedEx Standard Overnight, FedEx 2Day A.M., or FedEx Express Saver.
 No Signature Required
 Package may be left without obtaining a signature for delivery.
 Direct Signature
 Someone at recipient's address may sign for delivery. Fee applies.
 Indirect Signature
 If no one is available at recipient's address, someone at a neighboring address may sign for delivery. Fee applies for residential deliveries only. Fee applies.
 Does this shipment contain dangerous goods?
 (One box count to be checked.)
 No Yes
 \$5 per attached Shipper's Declaration. Yes
 Shipper's Declaration not required. Dry Ice
 Dry Ice, 3 UN 1845 _____ x _____ by _____
 Cargo Aircraft Only
 Dangerous goods (including dry ice) cannot be shipped in FedEx packaging or placed in a FedEx Express Drop Box.

7 Payment Bill to:
 Enter FedEx Acct. No. or Credit Card No. below. Credit Card Cash/Check
 Sender's Acct. No. or Credit Card No. Recipient Third Party Credit Card Cash/Check
 Total Packages _____ Total Weight _____ Credit Card Auth. _____
 Our liability is limited to USD\$100 unless you declare a higher value. See the current FedEx Service Guide for details.

fedex.com 1.800.GoFedEx 1.800.463.3339

fedex.com 1.800.GoFedEx 1.800.463.3339

Rev. Date 2/12 • Part #13134 • ©1994-2012 FedEx • PRINTED IN U.S.A. SRS

1266

MAINTENANCE FEE WAIVER CERTIFICATION

fm

FORM APPROVED
OMB NO. 1004-0114
Expires: October 31, 2016

SEE INSTRUCTIONS ON PAGE 2

1. This small miner waiver is filed for the assessment year beginning on September 1, 2014 and ending on September 1, 2015
2. The undersigned and all related parties owned ten or fewer mining claims, mill, or tunnel sites located and maintained on Federal lands in the United States of America on September 1, 2014
3. The undersigned have performed the assessment work required by law for each mining claim listed prior to filing this waiver and understand that by filing this form, the undersigned must file an affidavit of assessment work with the Bureau of Land Management (BLM) by the December 30th following the filing of this waiver.
4. The undersigned understand that if the assessment work obligation has not yet come due under 30 U.S.C. 28 (for those claims in their first assessment year only), a notice of intent to hold reciting this condition must be recorded by the December 30th following the filing of this waiver.
5. The undersigned understand that mill and tunnel sites may also be listed on this waiver and be waived from payment of the maintenance fee, and that a notice of intent to hold for these sites is required to be filed with the BLM by the December 30th following the filing of this waiver.
6. The undersigned understand and acknowledge that pursuant to 43 U.S.C. 1212 and 18 U.S.C. 1001, the filing or recording of a false, fictitious, or fraudulent document with the BLM may result in a fine of up to \$250,000, a prison term not to exceed five years, or both.
7. The mining claims, mill or tunnel sites for which this waiver from payment of the maintenance fees is requested are:

CLAIM OR SITE NAME	BLM RECORDATION SERIAL NUMBER
1. YELLOW GOLD	395763
2. YELLOW GOLD B	424576
3. YELLOW GOLD C	424577
4. YELLOW GOLD D	425095
5. RING GOLD	395762
6. RING GOLD B	424574
7. RING GOLD C	424575
8. RING GOLD D	425094
9. RED HILL 1	418496
10. RED HILL 2	420456

The owner(s) (claimants) of the above mining claims and sites are:

RON ROBRAN

(Owner's Name - Please Print)

W. 4160 ST RD 20

(Owner's Mailing Address)

Ron Robran

(Owner's Signature)

EAST TROY WI 53120

(City) (State) (Zip Code)

SANDY ROBRAN

(Owner's Name - Please Print)

W. 4160 ST RD 20

(Owner's Mailing Address)

Sandy Robran
EAST TROY WI 53120

(City) (State) (Zip Code)

(Owner's Name - Please Print)

(Owner's Mailing Address)

(Owner's Name - Please Print)

(Owner's Mailing Address)

(Owner's Signature)

(City) (State) (Zip Code)

(Owner's Signature)

(City) (State) (Zip Code)

RECEIVED
 BLM
 2014 SEP 25 P 2:14
 ARIZONA
 OFFICE

(Owner's Name - Please Print)	(Owner's Signature)		
(Owner's Mailing Address)	(City)	(State)	(Zip Code)

(Owner's Name - Please Print)	(Owner's Signature)		
(Owner's Mailing Address)	(City)	(State)	(Zip Code)

(Owner's Name - Please Print)	(Owner's Signature)		
(Owner's Mailing Address)	(City)	(State)	(Zip Code)

(Owner's Name - Please Print)	(Owner's Signature)		
(Owner's Mailing Address)	(City)	(State)	(Zip Code)

18 U.S.C. 1001 and 43 U.S.C. 1212 make it a crime for any person knowingly and willfully to make to any department or agency of the United States any false, fictitious or fraudulent statements or representations as to any matter within its jurisdiction.

INSTRUCTIONS

1. This certification is made under the provisions of 43 U.S.C. § 1744 and 30 U.S.C. §28-28k and the regulations thereunder (43 CFR Part 3830).
2. The claimant(s) must fill in the dates in paragraph 1 for the beginning and ending of the assessment year for which this waiver is sought.
3. The claimant(s) must fill in the date in paragraph 2 for the beginning of the assessment year for which this waiver is sought.
4. All claim and site names and BLM serial numbers must be listed for the mining claims, mill sites, and tunnel sites for which the waiver is sought.
5. All owners of the mining claims, mill sites, and tunnel sites and their addresses must be given.
6. This waiver form must be signed by all the claimants or their designated agent, in original form. If an agent is designated, a notarized designation of agent, signed by all of the claimants with proper address given, must be submitted with this waiver.
7. This form must be filed no later than September 1st for the upcoming assessment year in the BLM State Office where the mining claims or sites are recorded, or the waiver cannot be granted by the BLM. (Example: To obtain a waiver for the assessment year 2012, which begins on September 1, 2011, you must qualify for and file for a waiver no later than September 1, 2011, in the proper BLM State Office.)
8. For all mining claims which require assessment work, you must record an affidavit of labor on or before the December 30th immediately following the filing of this waiver. For all other mining claims or sites waived, you must record a notice of intent to hold on or before the December 30th immediately following the filing of this waiver.
9. Mill and tunnel sites may also be listed on this waiver and be waived from payment of the maintenance fee. A notice of intent to hold for these sites is required to be filed by the December 30th following the filing of this waiver.

RECEIVED
 BLM STATE OFFICE
 PHOENIX, ARIZONA
 SEP 25 P 2:42

FOR OFFICIAL USE ONLY

CERTIFIED MAIL

Ronald Robran
W4160 State Road 20
East Troy, WI 53120 ★

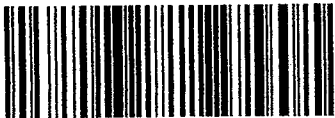

7007 2560 0003 0223 0597

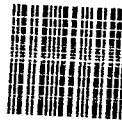

1000

95004

U.S. POSTAGE
PAID
EAST TROY, MI
53120
AUG 22 2014
AMOUNT

\$6.98

00050275-07

United States Dept. of the Interior
Bureau of Land Management
Arizona State Office
1 North Central Avenue, Suite 800
Phoenix, AZ 85004

ATTN: REANN MYERS
PHOENIX, ARIZONA

2014 AUG 25 P 2:42

RECEIVED
BLM AZ STATE OFFICE

266

Form 3830-2
(January 2004)

UNITED STATES DEPARTMENT OF THE INTERIOR
BUREAU OF LAND MANAGEMENT

RECEIVED
PHOENIX DISTRICT OFFICE

2014 AUG -8 AM 11: 10

RA

FORM APPROVED
OMB NO. 1004-0114
Expires: December 31, 2006

MAINTENANCE FEE WAIVER CERTIFICATION

SEE INSTRUCTIONS ON REVERSE

1. This small miner waiver is filed for the assessment year beginning at noon on September 1, 2014 and ending at noon on September 1, 2015
2. The undersigned and all related parties owned, ten or fewer mining claims, mill, or tunnel sites located and maintained on Federal lands in the United States of America on September 1, 2014
3. The undersigned have performed the assessment work required by law for each mining claim listed prior to filing this waiver and understand that by filing this form; an affidavit of assessment work must be recorded by the December 30th following the filing of this waiver.
4. The undersigned understand that if the assessment work obligation has not yet come due under 30 U.S.C. 28 (for those claims in their first assessment year only); a notice of intent to hold reciting this condition must be recorded by the December 30th following the filing of this waiver.
5. The undersigned understand that mill and tunnel sites may also be listed upon this waiver and be waived from payment of the maintenance fee; and that a notice of intent to hold for these sites is required to be recorded by the December 30th immediately following the filing of this waiver.
6. The undersigned understand and acknowledge that pursuant to 43 U.S.C. 1212 and 18 U.S.C. 1001; the filing or recording of a false, fictitious, or fraudulent document with the Bureau of Land Management may result in a fine of up to \$250,000, a prison term not to exceed five years, or both.
7. The mining claims, mill or tunnel sites for which this waiver from payment of the maintenance fees is requested are:

CLAIM OR SITE NAME	BLM RECORDATION SERIAL NUMBER
1. YELLOW GOLD	395763
2. YELLOW GOLD B	424576
3. YELLOW GOLD C	424577
4. YELLOW GOLD D	425095
5. RING GOLD	395762
6. RING GOLD B	424574
7. RING GOLD C	424575
8. RING GOLD D	425094
9. RED HILL 1	418496
10. RED HILL 2	420456

The owner(s) (claimants) of the above mining claims and sites are:

RON ROBRAN
 (Owner's Name - Please Print)
 W. 4160 ST RD 20
 (Street or P.O. Box)
 EAST TROY WI 53120
 (City) (State) (Zip Code)

Ron Robran
 (Owner's Signature)

SANDY ROBRAN
 (Owner's Name - Please Print)
 W. 4160 ST RD 20
 (Street or P.O. Box)
 EAST TROY WI 53120
 (City) (State) (Zip Code)

Sandy Robran
 (Owner's Signature)

(Owner's Name - Please Print)
 (Street or P.O. Box)
 (City) (State) (Zip Code)

PHOENIX, ARIZONA
 2014 AUG 14 A: 8: 22
 BLM REGIONAL OFFICE

(Continued on page 2)

~~RECEIVED
AUG 15 2014~~

(Owner's Name - Please Print)	(Owner's Signature)		
(Street or P.O. Box)	(City)	(State)	(Zip Code)
(Owner's Name - Please Print)	(Owner's Signature)		
(Street or P.O. Box)	(City)	(State)	(Zip Code)
(Owner's Name - Please Print)	(Owner's Signature)		
(Street or P.O. Box)	(City)	(State)	(Zip Code)
(Owner's Name - Please Print)	(Owner's Signature)		
(Street or P.O. Box)	(City)	(State)	(Zip Code)

INSTRUCTIONS

- | | |
|--|--|
| <ol style="list-style-type: none"> 1. This certification is made under the provisions of § 1744 of Title 43 and § 28-28k of Title 30 of the United States Code; and the regulations thereunder (43 CFR Part 3830). 2. The claimant(s) must fill in the dates in paragraph 1 for the beginning and ending of the assessment year for which this waiver is sought. 3. The claimant(s) must fill in the date in paragraph 2 for the beginning of the assessment year for which this waiver is sought. 4. All claim and site names and Bureau of Land Management (BLM) serial numbers must be listed for the mining claims, mill sites, and tunnel sites for which the waiver is sought. 5. All owners of the mining claims, mill sites, and tunnel sites and their addresses must be given. 6. This waiver form must be signed by all the claimants or their designated agent, in original form. If an agent is designated, a notarized designation of agent, signed by all of the claimants with proper address given, must be submitted with this waiver. | <ol style="list-style-type: none"> 7. This form must be filed no later than September 1st for the upcoming assessment year in the BLM State Office where the mining claims or sites are recorded, or the waiver cannot be granted by the BLM. (Example: to obtain a waiver for the assessment year 2000, which begins at noon on September 1, 1999, you must qualify for and file for a waiver no later than September 1, 1999, in the proper BLM State Office). 8. For all mining claims which require assessment work, you must record an affidavit of labor on or before the December 30th immediately following the filing of this waiver. For all other mining claims or sites waived, you must record a notice of intent to hold on or before the December 30th immediately following the filing of this waiver. 9. Mill and tunnel sites may also be listed upon this waiver and be waived from payment of the maintenance fee. A notice of intent to hold for these sites is required to be filed by the December 30th following the filing of this waiver. |
|--|--|

NOTICE/BURDEN HOURS STATEMENT

The Privacy Act of 1974, as amended, and the regulation in 43 CFR 2.48(d) provide that you be furnished the following information in connection with the information required by this certification of waiver from rental fees.

AUTHORITY: 30 U.S.C. 28-28k; 43 U.S.C. 1201, 1457, 1740, and 1744; and 43 CFR 3830.

PRINCIPLE PURPOSE: This information is to be used to verify that the owner(s) (claimants) of a mining claim has complied with 30 U.S.C. 28f and is entitled to perform assessment work in lieu of paying the maintenance fee for the mining claims listed on this form.

ROUTINE USE: (1) Adjudication of the claimant(s) certification of waiver from paying the maintenance fee otherwise required by 30 U.S.C. 28f. (2) Disclosure may be made to appropriate Federal agencies when location is made within the agency's geographic area of responsibility. (3) Information from the record and/or the record will be transferred to the appropriate Federal, State, or local agency, or a member of the public in response to a specific request for pertinent information. (4) Information may also be provided to the Department of Justice or in a proceeding before a court or adjudicative body; or to Federal, State, local or foreign agencies when needed for enforcement of civil or criminal codes or applicable regulations concerning title rights upon the public land.

EFFECT OF NOT PROVIDING INFORMATION: Disclosure of this information is required by 30 U.S.C. 28f and 43 CFR Part 3830 for those qualified claimants wishing to take the small miner waiver allowed. Failure to supply the information required in this form to support the claimants certification of waiver from payment of the otherwise required maintenance fees will result in the waiver being disallowed and the mining claims subject to forfeiture by BLM under 30 U.S.C. 28i.

The Paperwork Reduction Act of 1995 requires us to inform you that:

This information is being collected to allow the BLM to determine if you qualify for a waiver from the payment of \$100 per mining claim or site maintenance fee established in 30 U.S.C. 28f and the implementing regulations at 43 CFR 3830. A response to this request is required in accordance with the statute to obtain your benefit.

BLM would like you to know that you do not have to respond to this, or any other, Federal agency-sponsored information collection unless it displays a currently valid OMB control number.

Public reporting burden for this form is estimated to average 8 minutes (0.133 hours) per response, including time to review instructions, gathering and maintaining data, and completing and reviewing the form. Direct comments regarding this burden estimate, or any other aspect of this form, to the U.S. Department of the Interior, Bureau of Land Management, (1004-0114) Bureau Information Collection Clearance Officer (WO-630), Mail Stop 401 LS, 1849 C St., N.W., Washington, D.C. 20240.

FOR OFFICIAL USE ONLY

AMC 395761
 418496
 420456
 424574
 425094

When Recorded Return Document to:
RON ROBRAN
W. 4160 ST. RD. 20
EAST TROY, WIS. 53120

RECEIVED
 PHOENIX DISTRICT OFFICE
 2014 AUG -8 AM 11:50
 BUREAU OF LAND MANAGEMENT
 PHOENIX, AZ

Check here is this is a change of address.
 Telephone: 262-642-7891
 E-mail address: AISMITHS31@HOTMAIL.COM

AFFIDAVIT OF PERFORMANCE OF ANNUAL WORK

1. State of Arizona, County of YAVAPAI ss:
 2. I (Name) RON ROBRAN
 3. Reside at (Address) W. 4160 ST. RD. 20
 City EAST TROY County WALWORTH

BLM
 Date
 Stamp
 2014 AUG 14 A 8:23
 PHOENIX, ARIZONA
 CLIMATE OFFICE

State WI Zip 53120 being duly sworn, depose and say that I am a citizen of the United States, more than eighteen years of age, and that all of the facts set forth in this affidavit, subject to the provisions and penalties of 18 U.S.C. 1001 pertaining to the filing of false, fictitious, or fraudulent statements with the United States, are true and correct according to the best of my knowledge, information and belief.
 4. Owner's name and address (If not shown in Items 1-3 above).

5. That I am personally acquainted with the mining claim(s). The work and improvements were made by and at the expense of the owner(s) of said claim(s). Said contiguous group of claims, listed on this document, are situated in the _____ (optional) Mining District; YAVAPAI County, Arizona.

Line No.	AMC NUMBER	CLAIM/SITE NAME	COUNTY RECORDER DATA (If available)	TWP	RNG	SEC
1	395763	YELLOW GOLD	B4974 P 980	9 1/2 N	2 E	29
2	424576	YELLOW GOLD B	B.4987 P. 530	9 1/2 N	2 E	29
3	424577	YELLOW GOLD C	B.4987 P. 531	9 1/2 N	2 E	29
4	425095	YELLOW GOLD D	2014-0001388	9 1/2 N	2 E	29
5	395762	RING GOLD	B.4974 P. 981	9 1/2 N	2 E	32
6	424574	RING GOLD B	B.4987 P 529	9 1/2 N	2 E	32

210560 ✓

~~428903~~ No I filed different form

Form: MCF108
 Revised Jan. 2006
 Page 1 of 2

ENTERED
 AUG 15 2014
 BY: RAM

BLM
Date
Stamp

PHOENIX, ARIZONA

2014 AUG 14 A 8:23

7	424575	RING GOLD "C"	B.4987 P.528	9 1/2 N	2 E	32
8	425094	RING GOLD "D"	2014-0001389	9 1/2 N	2 E	32
9	418496	RED HILL #1	B4921 P 118	9 1/2 N	2 E	29
10	420456	RED HILL #2	B4933 P. 746	9 1/2 N	2 E	32

6. That between the dates starting at 12 o'clock noon on September 1, 20 13 and ending at 12 o'clock noon on September 1, 20 14 at least \$ 1200.00 dollars worth of work and improvements were done and performed upon said claim(s) or upon one or more of a contiguous group of claims for the benefit of all, wholly or partly outside of a contiguous group of claims for the benefit of all, not including the location work.

7. That the following persons were employed to perform the work and improvements described herein: ROBERT REAVES, RON ROBRAN, SANDY ROBRAN

8. That the work and improvements performed were: ACTIVE MINING ROAD WORK/ MAINTENANCE, TRASH CLEAN-UP

9. Dated: 8/5/14 Signature: Ron Robran

SUBSCRIBED AND SWORN TO before me, a Notary Public, this 5 day of August 20 14

By: Shannon R Wulf

Notary Public Shannon R Wulf

My Commission Expires August 1, 2017

Shannon R Wulf
NOTARY PUBLIC
STATE OF WISCONSIN

Bureau of Land Management
Arizona State Office
www.az.blm.gov

No. of Claims: 10 x \$10 = \$100.00
Check No.: 2076 Init. SW
Receipt No.: 3101178
For BLM Use Only

**UNITED STATES
DEPARTMENT OF THE INTERIOR
BUREAU OF LAND MANAGEMENT

COLLECTION TRANSMITTAL**

TO:
PHOENIX DISTRICT OFFICE (LLAZP00000)
21605 N 7TH AVE
PHOENIX AZ 85027
(623)580-5500

FROM:
PHOENIX DISTRICT OFFICE (LLAZP01000)
21605 N. 7TH AVENUE
PHOENIX AZ 85027 - 0000
(623)580-5500

CHECKS

REMITTER	CHECK NUMBER	AMOUNT
RONALD ROBRAN FARMS LLC	2076	100.00

REMARKS

SENT TO PDO IN ERROR FEDEX TO STATE OFFICE

08/08/2014
(Date)

DEBORAH E MORRELL
(Signed)

RECEIVED
 CLIMATE STATE OFFICE
 2014 AUG 14 A 8:22
 PHOENIX, ARIZONA

United States Department of the Interior
 Bureau of Land Management
 LANDS/RECREATION & PLANNING
 ONE N CENTRAL AVE
 PHOENIX, AZ 85004 -2203
 Phone: 602-417-9200

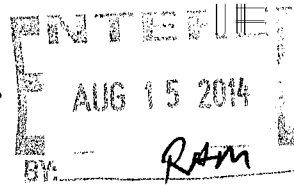

Receipt

No: 3101178

Transaction #: 3192731	
Date of Transaction: 08/14/2014	
CUSTOMER:	
RON ROBRAN W4160 STATE ROAD 20 EAST TROY, WI 53120-1710 US	

LINE #	QTY	DESCRIPTION	REMARKS	UNIT PRICE	TOTAL
1	1.00	LOCATABLE MINERALS / MINING CLAIMS-NOT NEW-UNADJUD, ONE AUTH NO. ONLY / MINING CLAIM MONEY RECEIVED CASES: AMC395763/\$100.00	MAINT FEE WAIVER (10) 2015 / POL (10) 2014	- n/a -	100.00
TOTAL:					\$100.00

PAYMENT INFORMATION					
1	AMOUNT:	100.00	POSTMARKED:	08/05/2014	
	TYPE:	CHECK	RECEIVED:	08/14/2014	
	CHECK NO:	2076			
	NAME:	RONALD ROBRAN FARMS LLC W4160 STATE ROAD 20 EAST TROY WI 53120-1710 US			

REMARKS
PLEASE ADDRESS ALL MINING CORRESPONDENCE AND FUTURE ANNUAL FILINGS TO THIS OFFICE, AS STATED ABOVE IN THE RECEIPT.

This receipt was generated by the automated BLM Collections and Billing System and is a paper representation of a portion of the official electronic record contained therein.

Ron Robran
W4160 State Rd 20
East Troy WI 53120

PLACE STICKER AT TOP OF ENVELOPE TO THE RIGHT
OF THE RETURN ADDRESS, FOLD AT DOTTED LINE
CERTIFIED MAIL™

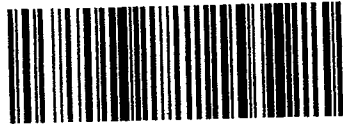

7007 2560 0003 0222 9799

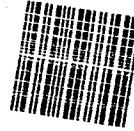

1000

9527

U.S. POSTAGE
PAID
EAST TROY, WI
53120
POSTAGE
AMOUNT

\$7.19
9006075-3-

United States Dept. of the Interior
Bureau of Land Management
Phoenix District
21605 North 7th Avenue
Phoenix, AZ 85027

PHOENIX, ARIZONA

2014 AUG 19 A 8:23

RECEIVED
11281
710E

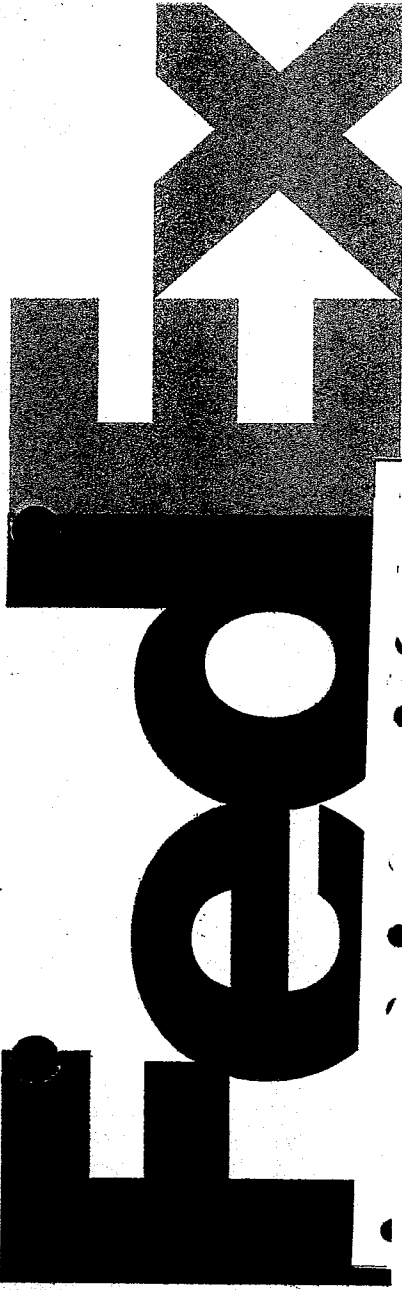

xpress

00085
00100

fedex.com 1.800.GoFedEx 1.800.463.3339

earthsmart

FedEx carbon-neutral envelope shipping

FedEx
TRK# 8034 0720 8551
0215

WED - 13 AUG AA
EXPRESS SAVER

98 ZSYA

85004
AZ-US
PHX



FID 399358 08AUG14 LUFA 51AC1/ECF7

FedEx Package Express **US Airbill** FedEx Tracking Number **8034 0720 8551**

1 From
Date 8/8/14
Sender's Name D. Russell Phone 623 880-5500
Company BUREAU OF LAND MANAGEMENT
Address 21605 N 7TH AVE
City PHOENIX State AZ ZIP 85027-2723

2 Your Internal Billing Reference

3 To
Recipient's Name Annabelle Houston Phone 602 417 9302
Company BLM
Address 1 South Camelback Ave
Address Suite 800
City Phoenix State AZ ZIP 85004



8034 0720 8551

4 Express Package Service *To most locations.
NOTE: Service order has changed. Please select carefully.
FedEx First Overnight
FedEx Priority Overnight
FedEx Standard Overnight
FedEx Express Saver
FedEx 2Day A.M.
FedEx 2Day
FedEx Express Saver

5 Packaging *Declared value limit \$500.
FedEx Envelope*
FedEx Pak*
FedEx Box
FedEx Tube
Other

6 Special Handling and Delivery Signature Options
SATURDAY Delivery
No Signature Required
Direct Signature
Indirect Signature
Does this shipment contain dangerous goods?
No
Yes
Dry Ice
Cargo Aircraft Only

7 Payment Bill to:
Sender
Recipient
Third Party
Credit Card
Cash/Check
Total Packages
Total Weight
Credit Card Acct.

Our liability is limited to US\$500 unless you declare a higher value. See the current FedEx Service Guide for details.

Rev. Date 2/12 - Part #93134 - ©1996-2012 FedEx - PRINTED IN U.S.A. 393

0215
276
ST 2
1
D
8551
08.13
ages up to 150 lbs.
charges over 150 lbs. use the
2x Express Freight 10 Airbill

fedex.com 1.800.GoFedEx 1.800.463.3339

Do not ship liquids, blood, or diagnostics in this packaging.

FedEx[®] Express

Extremely Urgent

Shipping, Meet Sustainability.

Now, getting it there on time also means getting it there sustainably, because FedEx works with BP Target Neutral to use carbon offsets for every envelope shipment. Of course, the envelope is made from 100% recycled content and is 100% recyclable.

It's part of EarthSmart[®]— FedEx solutions for a more sustainable world.

Go to earthsmart.fedex.com to learn more.

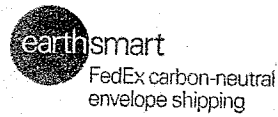

For FedEx Express[®] Shipments Only

Contents should be compatible with the container and packed securely. For shipping terms and conditions and our limits of liability, refer to the applicable FedEx Express shipping document, the current FedEx Service Guide, or conditions of carriage.

For more information on FedEx Express services, solutions, and shipping locations, go to fedex.com, or contact your nearest FedEx location.

© 2012 FedEx 155475/155476 REV 1/12

Insert shipping document here.

RECEIVED
BLM REGIONAL OFFICE
2011 AUG 14 A 8:23
PHOENIX, ARIZONA

UNITED STATES
DEPARTMENT OF THE INTERIOR
BUREAU OF LAND MANAGEMENT

MAINTENANCE FEE WAIVER CERTIFICATION

253

Amc 418496

Amc 420456
FORM APPROVED

OMB NO. 1004-0114

Expires: August 31, 2013

Amc 395761

SEE INSTRUCTIONS ON PAGE 2

- This small miner waiver is filed for the assessment year beginning on September 1, 2013, and ending on September 1, 2014.
- The undersigned and all related parties owned ten or fewer mining claims, mill, or tunnel sites located and maintained on Federal lands in the United States of America on September 1, 2013.
- The undersigned have performed the assessment work required by law for each mining claim listed prior to filing this waiver and understand that by filing this form, an affidavit of assessment work must be recorded by the December 30th following the filing of this waiver.
- The undersigned understand that if the assessment work obligation has not yet come due under 30 U.S.C. 28 (for those claims in their first assessment year only), a notice of intent to hold reciting this condition must be recorded by the December 30th following the filing of this waiver.
- The undersigned understand that mill and tunnel sites may also be listed upon this waiver and be waived from payment of the maintenance fee, and that a notice of intent to hold for these sites is required to be recorded by the December 30th immediately following the filing of this waiver.
- The undersigned understand and acknowledge that pursuant to 43 U.S.C. 1212 and 18 U.S.C. 1001, the filing or recording of a false, fictitious, or fraudulent document with the Bureau of Land Management may result in a fine of up to \$250,000, a prison term not to exceed five years, or both.
- The mining claims, mill or tunnel sites for which this waiver from payment of the maintenance fees is requested are:

CLAIM OR SITE NAME	BLM RECORDATION SERIAL NUMBER
1. RED HILL # 1	418496
2. RED HILL # 2	420456
3. RING GOLD	395762
4. YELLOW GOLD	395763
5.	
6.	
7.	
8.	
9.	
10.	

SEP 24 2013
AC 483 Entered - Manually

The owner(s) (claimants) of the above mining claims and sites are:

Ron Robran ✓
(Owner's Name - Please Print)
W. 4160 ST RD 20
(Street or P.O. Box)
EAST TROY WIS 53120
(City) (State) (Zip Code)

Ron Robran
(Owner's Signature)

SANDY ROBRAN ✓
(Owner's Name - Please Print)
W. 4160 ST RD 20
(Street or P.O. Box)
EAST TROY WIS. 53120
(City) (State) (Zip Code)

Sandy Robran
(Owner's Signature)

RECEIVED
BLM AZ OFFICE
SEP 24 2013
TUCSON, ARIZONA

(Owner's Name - Please Print)

(Street or P.O. Box)

(City) (State) (Zip Code)

(Owner's Signature)

ENTERED INTO COMPUTER
SEP 19 2013 RB

4/PB

(Owner's Name - Please Print)	(Owner's Signature)
(Street or P.O. Box)	(City) (State) (Zip Code)
(Owner's Name - Please Print)	(Owner's Signature)
(Street or P.O. Box)	(City) (State) (Zip Code)
(Owner's Name - Please Print)	(Owner's Signature)
(Street or P.O. Box)	(City) (State) (Zip Code)
(Owner's Name - Please Print)	(Owner's Signature)
(Street or P.O. Box)	(City) (State) (Zip Code)

Title 18 U.S.C. Section 1001 and Title 43 U.S.C. Section 1212 makes it a crime for any person knowingly and willfully to make to any department or agency of the United States any false, fictitious or fraudulent statements or representations as to any matter within its jurisdiction.

INSTRUCTIONS

1. This certification is made under the provisions of §1744 of Title 43 and § 28-28k of Title 30 of the United States Code; and the regulations thereunder (43 CFR Part 3830).
2. The claimant(s) must fill in the dates in paragraph 1 for the beginning and ending of the assessment year for which this waiver is sought.
3. The claimant(s) must fill in the date in paragraph 2 for the beginning of the assessment year for which this waiver is sought.
4. All claim and site names and Bureau of Land Management (BLM) serial numbers must be listed for the mining claims, mill sites, and tunnel sites for which the waiver is sought.
5. All owners of the mining claims, mill sites, and tunnel sites and their addresses must be given.
6. This waiver form must be signed by all the claimants or their designated agent, in original form. If an agent is designated, a notarized designation of agent, signed by all of the claimants with proper address given, must be submitted with this waiver.
7. This form must be filed no later than September 1st for the upcoming assessment year in the BLM State Office where the mining claims or sites are recorded, or the waiver cannot be granted by the BLM. (Example: To obtain a waiver for the assessment year 2012, which begins on September 1, 2011, you must qualify for and file for a waiver no later than September 1, 2011, in the proper BLM State Office.)
8. For all mining claims which require assessment work, you must record an affidavit of labor on or before the December 30th immediately following the filing of this waiver. For all other mining claims or sites waived, you must record a notice of intent to hold on or before the December 30th immediately following the filing of this waiver.
9. Mill and tunnel sites may also be listed upon this waiver and be waived from payment of the maintenance fee. A notice of intent to hold for these sites is required to be filed by the December 30th following the filing of this waiver.

RECEIVED
 BLM AZ STATE OFFICE
 PHOENIX, ARIZONA
 2012 AUG 12 PM 3:38

FOR OFFICIAL USE ONLY

CERTIFIED MAIL™

Ms Sandra Robran
4160 State Road 20
East Troy, WI 53120



RECEIVED
AZ STA

7007 2560 0003 0218 4678



1000

85004

U.S. POSTAGE
PAID
EAST TROY, WI
53120
AGE 08.13
AMOUNT

\$6.57
00069275-04

PHOENIX, ARIZONA

RETURN RECEIPT
REQUESTED

Bureau of Land Management
Arizona State Office
One North Central Avenue
Suite #800
Phoenix, AZ 85004-4427



CERTIFIED MAIL™

Ms Sandra Robran
4160 State Road 20
East Troy, WI 53120



RECEIVED
BY SIGNATURE

7007 2560 0003 0218 4678 JUN 12 01 2:33

PHOENIX, ARIZONA



1000



85004

U.S. POSTAGE
PAID
EAST TROY, WI
53120
REG. 957-13
AMOUNT

\$6.57
00069275-04

RETURN RECEIPT
REQUESTED

Bureau of Land Management
Arizona State Office
One North Central Avenue
Suite #800
Phoenix, AZ 85004-4427

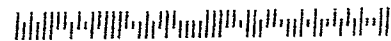

NOTICES

The Privacy Act and 43 CFR 2.48(d) require that you be furnished the following information in connection with the information requested by this form.

AUTHORITY: 30 U.S.C. 28f and 43 CFR part 3835 permit collection of the information requested by this form.

PRINCIPAL PURPOSE: The BLM will use the information you provide to verify that the owner(s) (claimants(s)) of a mining claim has/have complied with 30 U.S.C. 28f and 43 CFR part 3835 and is/are entitled to perform assessment work in lieu of paying the maintenance fee for the mining claims listed on this form.

ROUTINE USES: The BLM will only disclose this information in accordance with the provisions at 43 CFR 2.56(b) and (c).

EFFECT OF NOT PROVIDING INFORMATION: Disclosure of the requested information is required by 30 U.S.C. 28f and 43 CFR part 3835 for those claimants qualified to request the small miner waiver allowed. Failure to submit all the requested information or to complete this form will delay the BLM's processing of the form and may preclude the BLM's acceptance of the maintenance fee waiver request, which may result in forfeiture of the mining claim or site by the claimant.

The Paperwork Reduction Act requires us to inform you that:

The BLM collects this information to determine whether or not you are qualified for waiver of maintenance fees.

Submission of the requested information is necessary to obtain or retain a benefit.

You do not have to respond to this or any other Federal agency-sponsored information collection unless it displays a currently valid OMB control number.

BURDEN HOURS STATEMENT: Public reporting burden for this form is estimated to average 20 minutes per response, including the time for reviewing instructions, gathering and maintaining data, and completing and reviewing the form. You may submit comments regarding the burden estimate or any other aspect of this form to: U.S. Department of the Interior, Bureau of Land Management (1004-0114), Bureau Information Collection Clearance Officer (WO-630), Mail Stop 401 LS, 1849 C St., N.W., Washington, D.C. 20240.

RECEIVED
BLM ASST. DIR. FOR
2012 APR 12 11 20 AM '12

When Recorded Return Document to:

RON ROBRAN
W. 4160 ST RD 20
EAST TROY, WIS. 53120

Check here if this is a change of address.

Telephone: _____

E-mail address: _____

AFFIDAVIT OF PERFORMANCE OF ANNUAL WORK

1. State of Arizona, County of YAVAPAI ss:

2. I (Name) RON ROBRAN

3. Reside at (Address) W. 4160 ST. RD
20

City EAST TROY County WALWORTH

BLM
Date
Stamp

State WIS Zip 53120 being duly sworn, depose and say that I am a citizen of the United States, more than eighteen years of age, and that all of the facts set forth in this affidavit, subject to the provisions and penalties of 18 U.S.C. 1001 pertaining to the filing of false, fictitious, or fraudulent statements with the United States, are true and correct according to the best of my knowledge, information and belief.

4. Owner's name and address (If not shown in Items 1-3 above). _____

5. That I am personally acquainted with the mining claim(s). The work and improvements were made by and at the expense of the owner(s) of said claim(s). Said contiguous group of claims, listed on this document, are situated in the

(optional) Mining District; YAVAPAI County, Arizona.

Line No.	AMC NUMBER	CLAIM/SITE NAME	COUNTY RECORDER DATA (If available)	TWP	RNG	SEC
1	418496	RED HILL #1		9 1/2 N	2 E	29
2	420456	RED HILL #2		9 1/2 N	2 E	32
3	395762	RING GOLD		9 1/2 N	2 E	32
4	395763	YELLOW GOLD		9 1/2	2 E	32/29
5						
6						

Form: MCF108
Revised Jan. 2006

Page 1 of 2

ENTERED
SEP 03 2013
BY: AT

BLM
Date
Stamp

7					
8					
9					
10					

6. That between the dates starting at 12 o'clock noon on September 1, 20 12 and ending at 12 o'clock noon on September 1, 20 13 at least \$ 500.00 dollars worth of work and improvements were done and performed upon said claim(s) or upon one or more of a contiguous group of claims for the benefit of all, wholly or partly outside of a contiguous group of claims for the benefit of all, not including the location work.

7. That the following persons were employed to perform the work and improvements described herein: _____

ROBERT REAVES, RON BOBRAN, SANDY ROBRAN

8. That the work and improvements performed were: ACTIVE MINING, ROAD WORK, TRASH CLEAN UP

9. Dated: 8/14/13 Signature: Ron Robran

SUBSCRIBED AND SWORN TO before me, a Notary Public, this 18 day of August 20 13

By: First Merit Bank

Notary Public Brooke Methail

My Commission Expires July 14, 2017

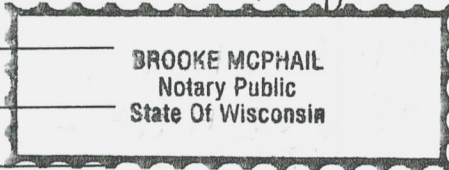

Bureau of Land Management
Arizona State Office
www.az.blm.gov

No. of Claims: 4 x \$10 = \$40.00
Check No.: 80626 Init. AMH
Receipt No.: 2859868
For BLM Use Only

We sent in the
Maintenance Fee
Waiver on these
claims already. You
received them on
8-12.

Ron Robran
262-642-7891

United States Department of the Interior
Bureau of Land Management
 LANDS/RECREATION & PLANNING
 ONE N CENTRAL AVE
 PHOENIX, AZ 85004 -2203
 Phone: 602-417-9200

Receipt

No: 2859868

Transaction #: 2945720	
Date of Transaction: 08/20/2013	
CUSTOMER:	
RON ROBRAN W 4160 ST RD 20 EAST TROY, WI 53120 US	

LINE #	QTY	DESCRIPTION	REMARKS	UNIT PRICE	TOTAL
1	1.00	LOCATABLE MINERALS / MINING CLAIMS- NOT NEW-UNADJUD, ONE AUTH NO. ONLY / MINING CLAIM MONEY RECEIVED CASES: AMC418496/\$40.00	PUL NOI (4) 2013	- n/a -	40.00
TOTAL:					\$40.00

PAYMENT INFORMATION					
1	AMOUNT:	40.00	POSTMARKED:	08/16/2013	
	TYPE:	CHECK	RECEIVED:	08/19/2013	
	CHECK NO:	18626			
	NAME:	ROBRAN, RON W 4160 ST RD 20 EAST TROY WI 53120 US			

REMARKS

This receipt was generated by the automated BLM Collections and Billing System and is a paper representation of a portion of the official electronic record contained therein.

Mr. Ronald Robran
W4160 State Road 20
East Troy, WI 53120-1710
SUPPORT OUR WOUNDED HEROES

CERTIFIED MAIL



7004 1160 0002 2007 6192

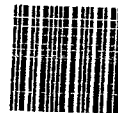

1000

85004

U.S. POSTAGE
PAID
EAST TROY, WI
53120
AUG 15, 13
AMOUNT

\$6.77
00069275-04

FIRST CLASS
MAIL

RETURN RECEIPT
REQUESTED

Bureau of Land Management.
Arizona State Office
One North Central Avenue
Suite #800
Phoenix, AZ 85004 - 4427

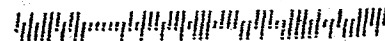

Mass Add/Delete/Update Action Data

Starting Serial Number

Ending Serial Number

420456

420456

Errors:

ACTION CODE 484 REQUIRED FOR LOCATION YR MAINT FEE - [AMC420456]

SEP 24 2013

*had to enter
AC 483 code manually.
PB*

per AT

	Action Data:	
Action Code:	483	Lookup
Action Remark:	2014	
Action Date:	08/12/2013	
Receipt Nr:		

Add **Delete** **Close**

=====
Total Amount Processed : \$0.00

	Update Action Data:	
Action Code:		Lookup
Action Remark:		
Action Date:		
Receipt Nr:		

Update

NOTICE!!

These documents have been scanned!

Do not place un-scanned documents beneath this notice!

Do not remove this notice from this file!

GPO Jacket No. 560-102
Print Order 61540
Rise Business Services, LLC
Job=AZ15 5/13/2019



Box Number= AZ15042



Claim Begin-End: AMC420456-AMC420456

6 Location Notices-Amendments and Supporting Documents



AZ15042-10

AMC420196-AMC421069

**DEPARTMENT OF THE INTERIOR
BUREAU OF LAND MANAGEMENT
MINING CLAIMS**

Run Date/Time: 01/31/2013 03:01 PM

(LIVE) Serial Register Page

Page 1 of 1

01 10-21-1976;090STAT0090;43USC1744

Case Type 384201: PLACER CLAIM

Claim Name: RED HILL #2

Commodity :

Case Disposition: ACTIVE

Required Maintenance Fee: \$280.00

Total Acres

40.000

Serial Number

AMC420456

Lead File Number

AMC420456

Name & Address

Int Rel

ROBRAN RON	W4160 STATE ROAD 20	EAST TROY, WI 53120-1710	CLAIMANT
ROBRAN SANDY	W4160 STATE ROAD 20	EAST TROY, WI 53120-1710	CLAIMANT

Mer Twp	Rng	Sec	Quadrant	District/Field Office	County	
14	0092N	0020E	032	NW,SW	HASSAYAMPA FO	YAVAPAI

Act Date	Code	Action	Action Remarks	Receipt Number
12/05/2012	403	LOCATION DATE		
12/27/2012	395	RECORDATION NOTICE RECD	1	2714951
12/27/2012	484	LOCATION YEAR / MAINTENANCE	2013;\$140	2714951
12/27/2012	501	ACCT ADV IN LEAD FILE	AMC420456;	
12/27/2012	685	ADDL/CURABLE MAINT FEE	2013;\$140	2714951

Line Nr Remarks

**DEPARTMENT OF THE INTERIOR
BUREAU OF LAND MANAGEMENT
MINING CLAIMS**

(LIVE) Serial Register Page

Run Date/Time: 02/06/2013 07:02 AM

Page 1 of 1

01 10-21-1976;090STAT0090;43USC1744
Case Type 384201: PLACER CLAIM
Claim Name: RED HILL #2
Commodity :
Case Disposition: ACTIVE
Required Maintenance Fee: \$280.00

Total Acres
40.000

Serial Number
AMC420456
Lead File Number
AMC420456

Name & Address

Int Rel

ROBRAN SANDY	W4160 STATE ROAD 20	EAST TROY, WI 53120-1710	CLAIMANT
ROBRAN RON	W4160 STATE ROAD 20	EAST TROY, WI 53120-1710	CLAIMANT

Mer Twp	Rng	Sec	Quadrant	District/Field Office	County
14	0092N	0020E	032	NW,SW	HASSAYAMPA FO
					YAVAPAI

Act Date	Code	Action	Action Remarks	Receipt Number
12/05/2012	403	LOCATION DATE		
12/27/2012	395	RECORDATION NOTICE RECD	1	2714951
12/27/2012	484	LOCATION YEAR / MAINTENANCE	2013;\$140	2714951
12/27/2012	392	MONIES RECEIVED	\$140.00;1	2714951
12/27/2012	501	ACCT ADV IN LEAD FILE	AMC420456;	
12/27/2012	685	ADDL/CURABLE MAINT FEE	2013;\$140	2714951

Line Nr Remarks

ENTERED INTO COMPUTER

FEB 06 2013 *FB*

Mass Add/Delete/Update Action Data

Starting Serial Number Ending Serial Number

420456

420456

	Action Data:
Action Code:	685 <input type="button" value="Lookup"/>
Action Remark:	2013
Action Date:	12/27/2012
Receipt Nr:	2714951

[AMC420456] - [Placer] - 685 - 2013;\$140

=====
Total Amount Processed : \$140.00

	Update Action Data:
Action Code:	<input type="text"/> <input type="button" value="Lookup"/>
Action Remark:	<input type="text"/>
Action Date:	<input type="text"/>
Receipt Nr:	<input type="text"/>

**DEPARTMENT OF THE INTERIOR
BUREAU OF LAND MANAGEMENT
MINING CLAIMS**

Run Date/Time: 02/05/2013 10:35 AM

(LIVE) Serial Register Page

Page 1 of 1

01 10-21-1976;090STAT0090;43USC1744
Case Type 384201: PLACER CLAIM
Claim Name: RED HILL #2
Commodity :
Case Disposition: ACTIVE
Required Maintenance Fee: \$280.00

Total Acres
40.000

Serial Number
AMC420456
Lead File Number
AMC420456

Name & Address			Int Rel
ROBRAN RON	W4160 STATE ROAD 20	EAST TROY, WI 53120-1710	CLAIMANT
ROBRAN SANDY	W4160 STATE ROAD 20	EAST TROY, WI 53120-1710	CLAIMANT

Mer Twp	Rng	Sec	Quadrant	District/Field Office	County	
14	0092N	0020E	032	NW,SW	HASSAYAMPA FO	YAVAPAI

Act Date	Code	Action	Action Remarks	Receipt Number
12/05/2012	403	LOCATION DATE		
12/27/2012	395	RECORDATION NOTICE RECD	1	2714951
12/27/2012	484	LOCATION YEAR / MAINTENANCE	2013;\$140	2714951
12/27/2012	501	ACCT ADV IN LEAD FILE	AMC420456;	

Line Nr Remarks

CBS Export Results Report

Include Resolved Records

Record Status

Error Records (E/M/I)

Accepted Records (A/W)

"On Hold" Records (H)

All Records (for s/n or receipt nr)

Exported, No Results From CBS

New (not yet exported)

Printable Format (legal/landscape)

Search Criteria

Enter export Date (mm/dd/yyyy)

Serial Number match (optional)

Receipt Nr (optional)

Export Nr (exclusive)

LR2000 User (defaults to login)

Responsible Area (Errors Only)

User (U,X)

Programmer (P,X)

All (U,P,X)

[User Guide](#)

Resend?	Export Nr	A/D	Serial Nr	Mult	Code	S Amount	Remarks	Receipt Nr	LR2000 User	#Msg	Resolved?	OK	Stat1	Area	CBS Msg 1	Stat2	Area	Msg 2	CBS 392 ID	392 S Amt	Action Update Date	Resend	Resend Orig	Export Date
<input type="checkbox"/>	4002734	A	AMC395762	480	10.00	2012	2714951	ATHROWER			<input type="checkbox"/>		A		ACCPT				1886277	40.00	1/16/2013 11:12			1/16/2013
<input type="checkbox"/>	4002735	A	AMC395763	480	10.00	2012	2714951	ATHROWER			<input type="checkbox"/>		A		ACCPT				1886277	40.00	1/16/2013 11:12			1/16/2013
<input type="checkbox"/>	4002736	A	AMC399922	480	10.00	2012	2714951	ATHROWER			<input type="checkbox"/>		A		ACCPT				1886277	40.00	1/16/2013 11:12			1/16/2013
<input type="checkbox"/>	4002737	A	AMC418496	481	10.00	2012	2714951	ATHROWER			<input type="checkbox"/>		A		ACCPT				1886277	40.00	1/16/2013 11:12			1/16/2013
<input type="checkbox"/>	4019618	A	AMC420456	685	140.00	2013	\$140	2714951	PAULINEB	1	<input type="checkbox"/>		E	U	INSUFFICIENT FUNDS ON RECEIPT						1/31/2013 14:55			1/31/2013

FEB 06 2013
 ENTERED INTO COMPUTER
 FEB 06 2013 PS

The Adjudicator needs to move the money first.
 Need to enter \$140.
 685 Code Entered!

2013
 M/Feb

Action Code Update

Serial-No: AMC420456

Status: ACTIVE

40 A

Bottom of Screen

	Del?	Date (mm/dd/yyyy)	Code	Action Taken	Action Remark	Receipt Nr	Ins User	Mod User
1	<input type="checkbox"/> X	12/05/2012	403	LOCATION DATE			PAULINEB	
2	<input type="checkbox"/> X	12/27/2012	395	RECORDATION NOTICE RECD	1	2714951	CBS_IMPT	
3	<input type="checkbox"/> X	12/27/2012	685	ADDL/CURABLE MAINT FEE	2013,\$140	2714951	PAULINEB	
4	<input type="checkbox"/> X	12/27/2012	501	ACCT ADV IN LEAD FILE	AMC420456;		PAULINEB	
5	<input type="checkbox"/> X	12/27/2012	484	LOCATION YEAR / MAINTENANCE FEE	2013,\$140	2714951	PAULINEB	

Actions: 5

Provide me with new occurrences

Please SAVE&CONTINUE Between DELETES and NEW/CHANGE Lines

Save & Continue

Save & Exit

Cancel

Lookup

Serial-No: AMC420456

Top of Screen

MINING CLAIM STATUS REPORT

DATA ENTERED 12/27/12 JAN 31 2013 ps

MTP Checked by nclt
GEO Checked by nclt

LEAD SERIAL NUMBER AMC 420456 thru AMC _____

OF CLAIMS & TYPE

_____ LODGE
1 PLACER
_____ ASSOCIATION PLACER
_____ MILL SITE
_____ TUNNEL SITE

CHARGES

Location Fee @ \$34 = \$ 34
Processing Fee @ \$15 = \$ 15
Maintenance Fee @ \$140 = \$ 140
Overage (+) \$ _____
Shortage (-) \$ _____
Other Fees \$ 140
TOTAL \$ 329 -

TOTAL CLAIM ACREAGE? 40
OF LOCATORS? 2

DOCUMENTS RECEIVED VIA -

Over-the-Counter Mail

TIMELY FILED?

Yes No

LEGAL DESCRIPTION - T 9 1/2 N R 2E SEC 32
T _____ R _____ SEC _____
T _____ R _____ SEC _____
T _____ R _____ SEC _____

BLM FOREST SERVICE SUBJ TO PL 359: Yes No
WILDERNESS AREA: No Yes

SPLIT ESTATE - N/A SX PX SRHA OTHER
Proper Notice Filed if Located on SHRA Lands? N/A Yes No

RECONVEYED MINERALS ON BLM LANDS REQUIRE OPENING ORDERS FROM 1944 TO 1993 -

Open to Entry on: _____ N/A

COMMENTS/STATUS - VOID PARTIALLY VOID PVT MINERALS WITHDRAWN LANDS
OTHER Opening order for lands on May 7, 1990

Claimant acknowledges that portions of the following claims(s) site(s) may be void or voidable.

AMC 420456

Printed Name of Claimant _____ Signature of Claimant _____

***** FINAL ADJUDICATION *****

DATE 6-12-13 INITIALS RS

LOCATION NOTICE FOR PLACER MINING CLAIM

NOTICE IS HEREBY GIVEN that the Red Hill #2
placer mining claim has been located by
Ron & Sandy Robcan whose current mailing
address is W. 4160 St. Rd 20
East Troy, WI 53120

RECEIVED
BLM, AZ STATE OFFICE
2012 DEC 27 P 2:18
PHOENIX, AZ
BLM
Date
Stamp

The general course of this claim is NORTH - SOUTH and it is situated in
Yavapai County, Arizona.

This claim is 2640 feet in length and 660 feet in width. This claim runs from the
location monument on which this location notice is posted approximately 2640 feet in a North
direction to the N.E. end line and 660 feet in a West direction to the N.W. end line.
This claim is marked by four monuments, one at each corner of the claim.

The location monument on which this notice is posted is situated within Section 32, Township
9.5 N, Range 2 E, Gila Salt River Base and Meridian, Arizona. This claim encompasses
portions of the following legal subdivision(s) if located by legal subdivision or the following quarter section (s),
section (s), Township (s) and Range (s) NW & SW 32 9.5 N 2 E
Gila Salt River Base and Meridian, Arizona.

The locality of this claim with reference to some natural object or permanent monument and additional
information (if any) concerning its locality are as follows: 3 miles S.W. Bumble
Bee AZ

DATED AND POSTED on the ground this 5th day of December, 2012
LOCATOR (s) Robert L. Brown AGENT

Form MCF102
Revised July 2005

This form is available from the Arizona Department of Mines & Mineral Resources and may be reproduced.

AH0420456

MINING CLAIM MAP

Lode () Placer ()

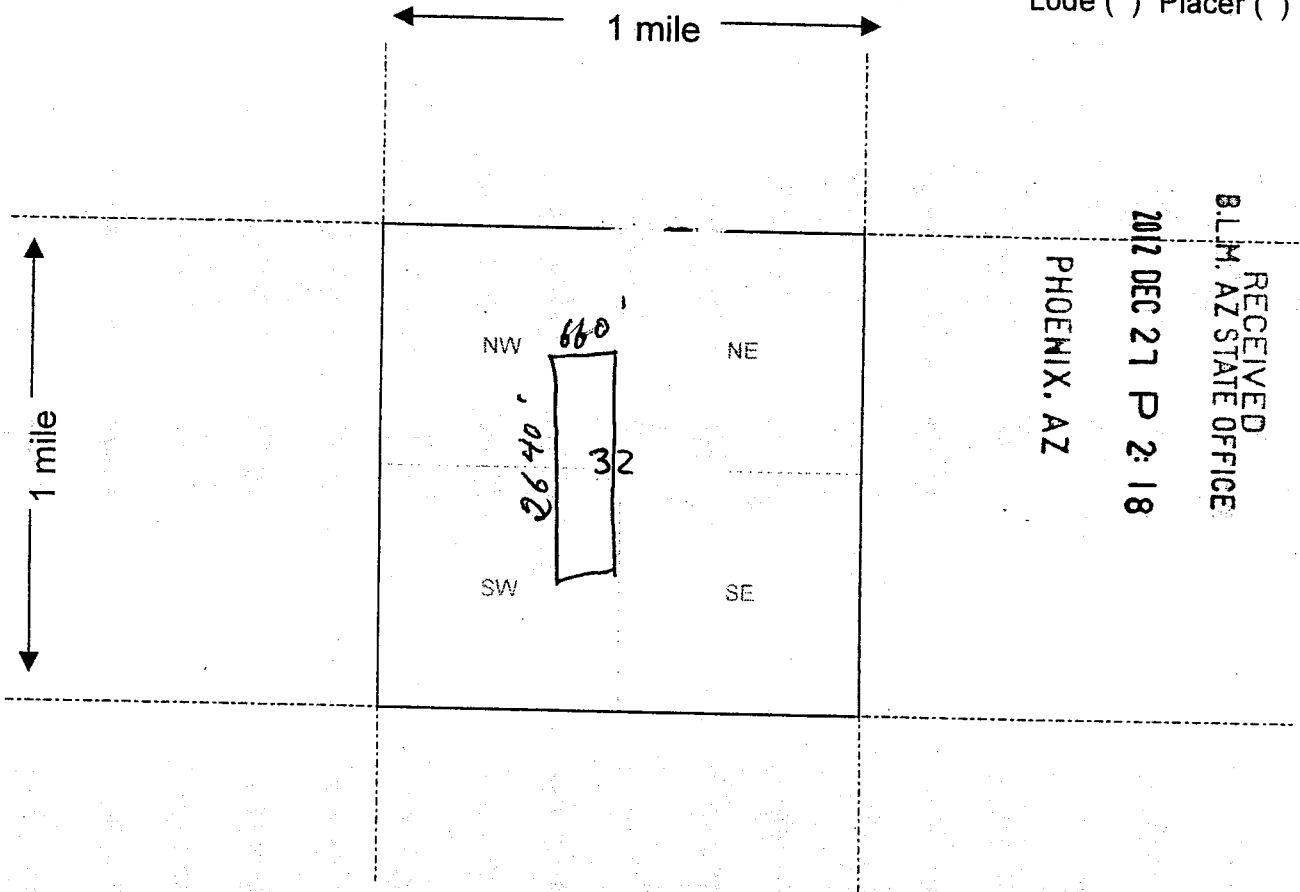

RECEIVED
B.L.M. AZ STATE OFFICE
2012 DEC 21 P 2:18
PHOENIX, AZ

AHC420456

Scale: 1" = 2000 feet

1. The above map depicts the Red Hill # 2 mining claim, which is located in Section (s) 32, Township 9.5 N, Range 2 E, Gila and Salt River Base and Meridian, Yavapai County, Arizona.

2. The type of corner and location monuments used are as follows: 4" x 4" PVC w/cap

3. The bearings and distances in degrees and feet between claim corners are as depicted on the map.

Form MCF100a
Revised July 2005

This form is available from the Arizona Department of Mines & Mineral Resources and may be reproduced.



Input Parameters for Geographic Report with Land

System Id = CR

Admin State = AZ

Geo State =

Casetype Begins With

Case Disp Txt =

Mer Twp Rng = 14 0092N 0020E

Section = 032, 999

Mtrs =

Commodity =

Commodity Txt =

Pending Org =

Pend Org Decode =

Total Rows Returned: 15

RUN TIME: 10:37 AM

UNITED STATES DEPARTMENT OF INTERIOR
BUREAU OF LAND MANAGEMENT
GEOGRAPHIC REPORT WITH LAND
Sorted by Serial Number

RUN DATE: 06/12/2013
Page 1 of 3

Adm State: AZ

Serial Number: AZA 002936
Total Case Acres: 65,501.000

<u>Casetype</u>	<u>Case Disp</u>				<u>Sect</u>	<u>Sur Typ</u>	<u>Sur Num</u>	<u>Suff</u>	<u>Subdivision</u>	<u>Act Pend</u>
246100	AUTHORIZED	14	0092N	0020E	032	ALIQ			E2;	

Serial Number: AZA 022699PT
Total Case Acres: 12,382.940

<u>Casetype</u>	<u>Case Disp</u>				<u>Sect</u>	<u>Sur Typ</u>	<u>Sur Num</u>	<u>Suff</u>	<u>Subdivision</u>	<u>Act Pend</u>
221006	AUTHORIZED	14	0092N	0020E	032	ALIQ			W2;	

Serial Number: AZA 024703
Total Case Acres: 1.000

<u>Casetype</u>	<u>Case Disp</u>				<u>Sect</u>	<u>Sur Typ</u>	<u>Sur Num</u>	<u>Suff</u>	<u>Subdivision</u>	<u>Act Pend</u>
380913	CLOSED	14	0092N	0020E	032	ALIQ			S2;	

Serial Number: AZA 025729
Total Case Acres: 1.000

<u>Casetype</u>	<u>Case Disp</u>				<u>Sect</u>	<u>Sur Typ</u>	<u>Sur Num</u>	<u>Suff</u>	<u>Subdivision</u>	<u>Act Pend</u>
380913	CLOSED	14	0092N	0020E	032	FF		1	PART;	

Serial Number: AZA 025851
Total Case Acres: 10.000

<u>Casetype</u>	<u>Case Disp</u>				<u>Sect</u>	<u>Sur Typ</u>	<u>Sur Num</u>	<u>Suff</u>	<u>Subdivision</u>	<u>Act Pend</u>
380910	CLOSED	14	0092N	0020E	032	ALIQ			W2;	

Serial Number: AZA 028653
Total Case Acres: 1.000

<u>Casetype</u>	<u>Case Disp</u>				<u>Sect</u>	<u>Sur Typ</u>	<u>Sur Num</u>	<u>Suff</u>	<u>Subdivision</u>	<u>Act Pend</u>
		14	0092N	0020E						

RUN TIME: 10:37 AM

UNITED STATES DEPARTMENT OF INTERIOR
BUREAU OF LAND MANAGEMENT
GEOGRAPHIC REPORT WITH LAND
Sorted by Serial Number

RUN DATE: 06/12/2013
Page 2 of 3

Adm State: AZ

380913 CLOSED 032 FF 1 PART;

Serial Number: AZA 028943
Total Case Acres: 1.000

<u>Casetype</u>	<u>Case Disp</u>	14	0092N	0020E	<u>Sect</u>	<u>Sur Typ</u>	<u>Sur Num</u>	<u>Suff</u>	<u>Subdivision</u>	<u>Act Pend</u>
293200	CLOSED				032	FF		1	PART OF NE;	

Serial Number: AZA 03102401
Total Case Acres: 112,637.000

<u>Casetype</u>	<u>Case Disp</u>	14	0092N	0020E	<u>Sect</u>	<u>Sur Typ</u>	<u>Sur Num</u>	<u>Suff</u>	<u>Subdivision</u>	<u>Act Pend</u>
231113	CLOSED				032	ALIQ			ALL;	

Serial Number: AZA 031209
Total Case Acres: 1.000

<u>Casetype</u>	<u>Case Disp</u>	14	0092N	0020E	<u>Sect</u>	<u>Sur Typ</u>	<u>Sur Num</u>	<u>Suff</u>	<u>Subdivision</u>	<u>Act Pend</u>
380913	CLOSED				032	ALIQ			ALL;	

Serial Number: AZA 031354
Total Case Acres: 1.000

<u>Casetype</u>	<u>Case Disp</u>	14	0092N	0020E	<u>Sect</u>	<u>Sur Typ</u>	<u>Sur Num</u>	<u>Suff</u>	<u>Subdivision</u>	<u>Act Pend</u>
380913	CLOSED				032	ALIQ			ALL;	

Serial Number: AZA 031730
Total Case Acres: 1.000

<u>Casetype</u>	<u>Case Disp</u>	14	0092N	0020E	<u>Sect</u>	<u>Sur Typ</u>	<u>Sur Num</u>	<u>Suff</u>	<u>Subdivision</u>	<u>Act Pend</u>
293200	CLOSED				032	FF			PORTION OF;	

RUN TIME: 10:37 AM

UNITED STATES DEPARTMENT OF INTERIOR
BUREAU OF LAND MANAGEMENT
GEOGRAPHIC REPORT WITH LAND
Sorted by Serial Number

RUN DATE: 06/12/2013
Page 3 of 3

Adm State: AZ

Serial Number: AZA 031851
Total Case Acres: 1.000

<u>Casetype</u>	<u>Case Disp</u>				<u>Sect</u>	<u>Sur Typ</u>	<u>Sur Num</u>	<u>Suff</u>	<u>Subdivision</u>	<u>Act Pend</u>
293200	AUTHORIZED	14	0092N	0020E	032	FF			PORTION OF;	

Serial Number: AZA 032323
Total Case Acres: 5.000

<u>Casetype</u>	<u>Case Disp</u>				<u>Sect</u>	<u>Sur Typ</u>	<u>Sur Num</u>	<u>Suff</u>	<u>Subdivision</u>	<u>Act Pend</u>
380910	CLOSED	14	0092N	0020E	032	FF			PORTION OF;	

Serial Number: AZA 033433
Total Case Acres: 1.000

<u>Casetype</u>	<u>Case Disp</u>				<u>Sect</u>	<u>Sur Typ</u>	<u>Sur Num</u>	<u>Suff</u>	<u>Subdivision</u>	<u>Act Pend</u>
293200	EXPIRED	14	0092N	0020E	032	FF			PORTION OF;	

Serial Number: AZA 033821
Total Case Acres: 1.000

<u>Casetype</u>	<u>Case Disp</u>				<u>Sect</u>	<u>Sur Typ</u>	<u>Sur Num</u>	<u>Suff</u>	<u>Subdivision</u>	<u>Act Pend</u>
293200	AUTHORIZED	14	0092N	0020E	032	FF			PORTION OF;	

TOWNSHIP 9½ NORTH RANGE 2 EAST OF THE GILA AND SALT RIVER MERIDIAN, ARIZONA

YAVAPAI COUNTY
HASSAYAMPA FIELD OFFICE

STATUS OF PUBLIC DOMAIN
LAND AND MINERAL TITLES
AND ACQUIRED LANDS

INDEX TO SEGREGATED TRACTS				
TRACT NO	ORIGINAL SURVEY			
	T	R	SEC	SUBDIVISION

FOR ORDERS AFFECTING DISPOSAL OR USE OF UNIDENTIFIED LANDS WITHDRAWN FOR CLASSIFICATION, MINERALS, WATER AND/OR OTHER PUBLIC PURPOSES, REFER TO INDEX OF MISCELLANEOUS DOCUMENTS.

MDS 39 SE

AZA 27240 100' E 230' W
Sec 9 : E1/2NE1/4, NW1/4SE1/4, SW1/4
Sec 31 : Lot 4, NE1/4, NW1/4SE1/4, E1/2SW1/4
Sec 32 : NW1/4NW1/4

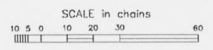
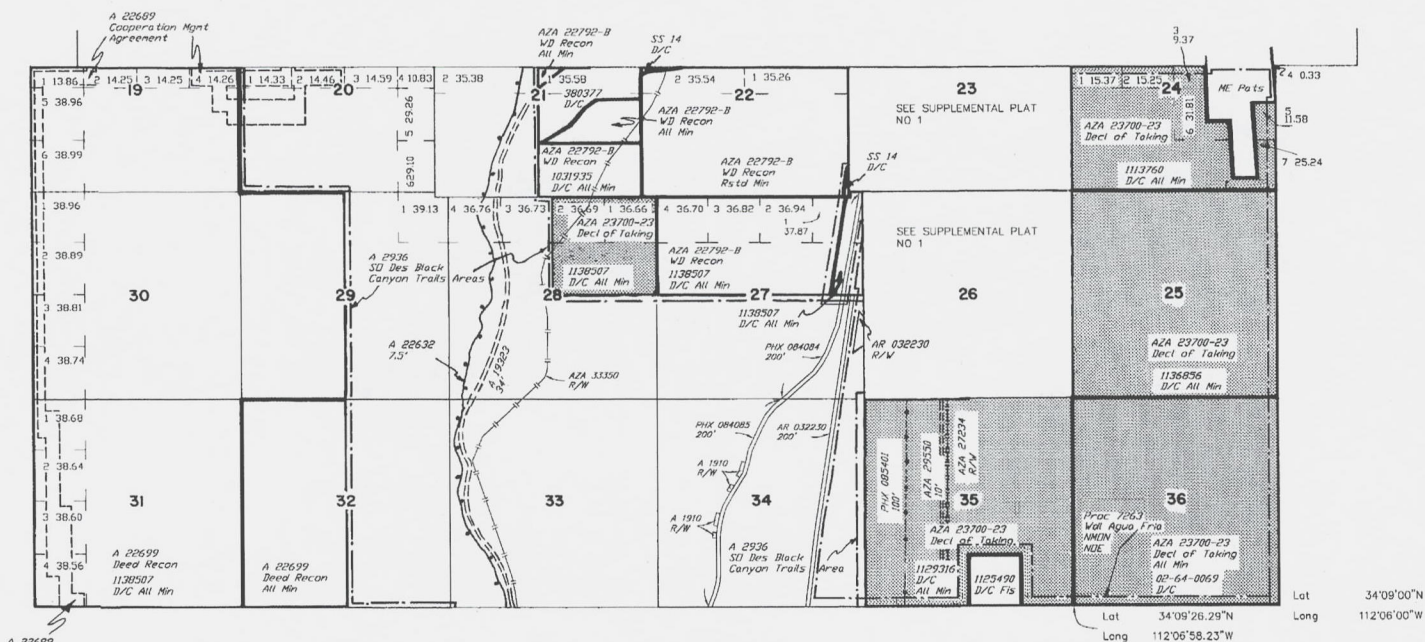

WARNING STATEMENT
This plot is the Bureau's Record of Title, and should be used only as a graphic display of the township survey data. Records hereon do not reflect title changes which may have been effected by lateral movements of rivers or other bodies of water. Refer to the coastal surveys for official survey information.

CURRENT TO	GS	T	9½ N
11-20-2008	PV	R	2 E

A 22689 Cooperation Mgmt Agreement

Lat 34°09'00"N
Long 112°06'00"W